

OPERATIONAL REGULATIONS

**SIGNAGE
COMPENDIUM**



Contents

<u>DOME</u>	4
External	
<u>EXHIBITION HALLS</u>	6
External	
Internal	
North Pod	
South Pod	
Halls 5 & 6	
<u>CHARLES MOSES STADIUM</u>	16
External	
Internal	
<u>PAVILIONS</u>	20
Downes	
Falkiner	
Grace	
Mackay	
Munro	
Murchison	
Paddington	
Howie	
<u>STADIUM</u>	24
External	
<i>Vom 3 Tunnel</i>	31
<i>Scoreboard</i>	33
Internal	
<i>Sydney Royal Stand Foyers</i>	35
<i>Skydeck</i>	36
<i>Charley Room</i>	38
<i>Change Room 1</i>	40
<i>Change Room 2</i>	41
<u>PRECINCT</u>	43
External	
<u>DIGITAL SIGNAGE</u>	47
<u>SIGNAGE REQUIREMENTS</u>	54

DOME



EXTERNAL
Dome Entrance Foyer



LARGE BANNER

MATERIAL	WIDTH	HEIGHT	QTY
PVC	12400mm	5150mm	1

SMALL BANNER

MATERIAL	WIDTH	HEIGHT	QTY
PVC	7500mm	4500mm	1

INSTALLATION: Catenry Wire installation. Refer to rigging company for engineering.

EXTERNAL
Wall Banner



WALL BANNER

MATERIAL	PVC
WIDTH	5070mm
HEIGHT	3550mm
QTY	6

INSTALLATION: Top: Eyelets
Bottom: Rope edge

EXHIBITION HALLS



EXTERNAL
Dome Entrance Foyer



SPECIFICATIONS

MATERIAL	PVC
WIDTH	9630mm
HEIGHT	3600mm
QTY	2 (per hall)

INSTALLATION: All sides: Eyelets

EXTERNAL
External Foyer Wall



SPECIFICATIONS

MATERIAL	PVC
WIDTH	2300mm
HEIGHT	2300mm
QTY	2 (per hall)

EXTERNAL
Side Triangle

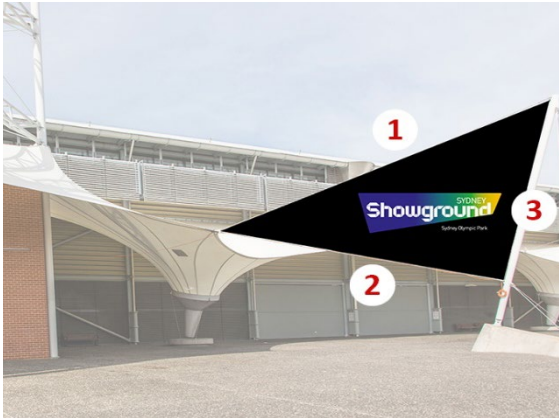

SPECIFICATIONS

MATERIAL	SIDE 1	SIDE 2	SIDE 3	QTY
PVC	12150mm	10030mm	6750mm	2 (per hall)

SQUARED OFF CORNERS

SIDE 1-2	SIDE 1-3	QTY
120mm (W)	250mm (W)	2

INSTALLATION: All sides: PVC Banner, Eyelets All Sides

EXTERNAL
Side Triangle



SPECIFICATIONS

MATERIAL	PVC
SIDE 1	8100mm
SIDE 2	8100mm
SIDE 3	4000mm
QTY	2 (per hall)

INSTALLATION: All sides: Eyelets

INTERNAL

Internal Pod Signage (Hall 2 - 4)



NORTH PODS LEVEL 2
INTERNAL WINDOWS LHS & RHS

TOP HALF	W 1650 x H 950mm
BOTTOM HALF	W 1650 x H 1130mm
MATERIAL	Banner/Corflute/Decal

INTERNAL

North Pod – Level 2 Front Window



NORTH POD LEVEL 2
FRONT WINDOW

TOP HALF	W 2200 x H 1100mm
BOTTOM HALF	W 2200 x H 1100mm
MATERIAL	Banner/Corflute/Decal

INTERNAL
North Pod Foyer



DOORS X 2

WIDTH	4800mm
HEIGHT	560mm

SIDE OF WALL FOYER

WIDTH	2400mm
HEIGHT	1200mm

INTERNAL
South Pods – Level 2



SOUTH PODS LEVEL 2
INTERNAL WINDOWS LHS & RHS

TOP HALF	W 1650 x H 950mm
BOTTOM HALF	W 1650 x H 1130mm
MATERIAL	Banner/Corflute/Decal

INTERNAL
South Pod – Level 2 Front Window



SOUTH POD LEVEL 2
FRONT WINDOW

TOP HALF	W 2200 x H 1100mm
BOTTOM HALF	W 2200 x H 1100mm
MATERIAL	Banner/Corflute/Decal

EXTERNAL
Hall 5A Main Entry Foyer – Left Hand Side



HALL 5A MAIN ENTRY FOYER
LEFT HAND SIDE

DIMENSIONS	W 15500 x H 1300mm
MATERIAL	PVC Track Mounted

INSTALLATION: Sail track on top deck and eyelets on the bottom.

LOCATION: Corner of Grand Pde & Showground Rd existing Southee Complex Entry point

EXTERNAL
Hall 5A Main Entry Foyer



HALL 5A MAIN ENTRY FOYER
RIGHT HAND SIDE

DIMENSIONS	W 20070 x H 1300mm
MATERIAL	PVC Track Mounted

INSTALLATION: Sail track on top deck and eyelets on the bottom.

LOCATION: Corner of Grand Pde & Showground Rd existing Southee Complex Entry point

EXTERNAL
Hall 5A Function Room 3 Entry



HALL 5A FUNCTION ROOM 3 ENTRY
SHOWGROUND RD

DIMENSIONS	5820 X 4000 x 2100mm
MATERIAL	PVC Corner Eyelets

LOCATION: Showground Rd – Outside Southee 3

EXTERNAL

Hall 5A Main Entry Point



HALL 5A MAIN ENTRY POINT
ABOVE MAIN ENTRY DOORS

DIMENSIONS	W 10600 x H 2300mm
MATERIAL	PVC Cable Ties to existing frame

INSTALLATION: Roof access ticket is required to install this signage. Please speak to your event representative for further information

LOCATION: Corner of Grand Pde & Showground Rd existing Southee Complex Entry point

EXTERNAL

Halls 5 & 6 – Riverina Ave



HALLS 5 & 6 – RIVERINA AVE
ENTRY DOORS

DIMENSIONS	W 1160 x 2650mm
MATERIAL	Decals

LOCATION: Riverina Side of Halls 5 & 6 (Above Entry Doors)

Halls 5 & 6 – Window Banners



HALLS 5 & 6 – RIVERINA AVE
ENTRY DOORS

DIMENSIONS	W 7340 x 2735mm
MATERIAL	Fabric Stretch, with silicon edge Existing frame is in place

EXTERNAL

Halls 5 & 6 – Riverina Ave



HALLS 5 & 6 – RIVERINA AVE
BANNER LOCATION

DIMENSIONS	W 4800 x H 9000mm Top Width 4000mm
MATERIAL	PVC / Mesh Banner with eyelets

LOCATION: Riverina Side of Halls 5 & 6 (2 Banner Points)

INTERNAL

Halls 5A Foyer



HALLS 5A Foyer
SIDE WALLS OF FOYER

DIMENSIONS	H 2500 X H 6000 (to 3phase outlet)
MATERIAL	PVC Banner

LOCATION: Entry way of Hall 5A Foyer

INTERNAL
Hall 5A Foyer



HALL 5A FOYER
ABOVE ENTRY DOORS TO HALL 5A

DIMENSIONS	H 720 X W 4100
MATERIAL	3mm Corflute

LOCATION: Above entry doors in Hall 5A foyer entering Hall 5A

INTERNAL
Halls 5 & 6 – Rigging Opportunities



HALLS 5 & 6 – RIVERINA AVE
2 BANNER POINTS

Custom Rigging Internal

Example only

LOCATION: Custom Rigging Internal – Example only

INTERNAL
Hall 5A Foyer



HALL 5A FOYER
ABOVE ENTRY DOORS TO HALL 5A

DIMENSIONS	H 720 X W 4100
MATERIAL	3mm Corflute

LOCATION: Above entry doors in Hall 5A foyer entering Hall 5A

INTERNAL
Halls 5 & 6 – Rigging Opportunities



HALLS 5 & 6 – RIVERINA AVE
CUSTOM RIGGING INTERNAL

Example only

LOCATION: Custom Rigging Internal – Example only

Halls 5 & 6



HALLS 5 & 6
CUSTOM RIGGING INTERNAL

Example only

LOCATION: Custom Rigging Internal – Example only

CHARLES MOSES STADIUM



SIGNAGE COMPENDIUM
CHARLES MOSES STADIUM

EXTERNAL
Charles Moses Entry Square



SPECIFICATIONS

MATERIAL	PVC
WIDTH	2200mm
HEIGHT	2200mm
QTY	1

INSTALLATION: All sides: Eyelets

EXTERNAL
Charles Moses Entry Banner



SPECIFICATIONS

MATERIAL	PVC
WIDTH	6600mm
HEIGHT	2000mm
QTY	1

SIGNAGE COMPENDIUM
CHARLES MOSES STADIUM

INSTALLATION: All sides: Eyelets

INTERNAL
Gantry Signage

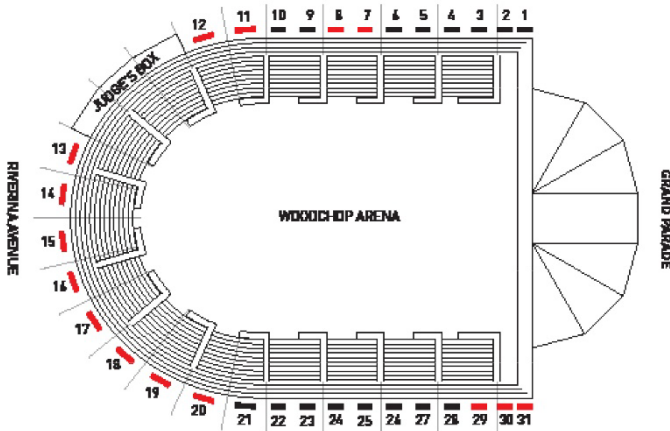

Gantry Signage Internal LHS



Gantry Signage Internal LHS

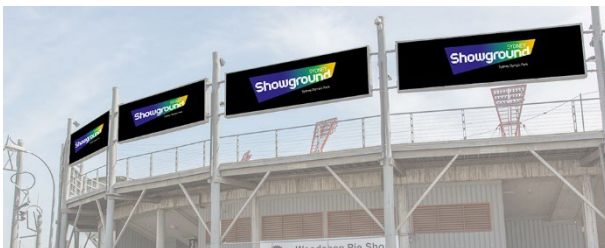

SITES

SITE 1	2.53m x 1.8m
SITE 2	2.44m x 1.8m
SITE 3	3.87m x 1.8m
SITE 4	3.87m x 1.8m
SITE 5	3.83m x 1.8m
SITE 6	3.8m x 1.8m
SITE 7	3.85m x 1.8m
SITE 8	3.95m x 1.8m
SITE 9	3.86m x 1.8m
SITE 10	3.86m x 1.8m
SITE 11	4.95m x 1.8m
SITE 12	5.6m x 1.8m
SITE 13	5.77m x 1.8m
SITE 14	5.9m x 1.8m
SITE 15	6.01m x 1.8m
SITE 16	6.01m x 1.8m
SITE 17	5.95m x 1.8m
SITE 18	6.0m x 1.8m
SITE 19	5.98m x 1.8m
SITE 20	5.94m x 1.8m
SITE 21	4.96m x 1.8m
SITE 22	3.91m x 1.8m
SITE 23	3.81m x 1.8m
SITE 24	3.92m x 1.8m
SITE 25	3.81m x 1.8m
SITE 26	3.9m x 1.8m
SITE 27	3.86m x 1.8m
SITE 28	3.81m x 1.8m
SITE 29	3.87m x 1.8m
SITE 30	2.51m x 1.8m
SITE 31	2.48m x 1.8m

PAVILIONS



EXTERNAL
Downes Pavilion



SPECIFICATIONS

MATERIAL	PVC
WIDTH	6600mm
HEIGHT	2000mm
QTY	3

EXTERNAL
Falkiner Pavilion



SPECIFICATIONS

MATERIAL	PVC
WIDTH	6600mm
HEIGHT	2000mm
QTY	2

INSTALLATION: All sides: Eyelets

EXTERNAL
Grace Pavilion



SPECIFICATIONS

MATERIAL	PVC
WIDTH	6600mm
HEIGHT	2000mm
QTY	1

INSTALLATION: All sides: Eyelets

EXTERNAL
Mackay Pavilion



SPECIFICATIONS

MATERIAL	PVC
WIDTH	6600mm
HEIGHT	2000mm
QTY	1

INSTALLATION: All sides: Eyelets

EXTERNAL
Munro Pavilion



SPECIFICATIONS

MATERIAL	PVC
WIDTH	6600mm
HEIGHT	2000mm
QTY	3

EXTERNAL
Murchison Pavilion



SPECIFICATIONS

MATERIAL	PVC
WIDTH	6600mm
HEIGHT	2000mm
QTY	4

INSTALLATION: All sides: Rope edge

EXTERNAL
Paddington Pavilion



SPECIFICATIONS

MATERIAL	PVC
WIDTH	6600mm
HEIGHT	2000mm
QTY	1

INSTALLATION: All sides: Eyelets

EXTERNAL
Howie Pavilion



SPECIFICATIONS

MATERIAL	PVC
WIDTH	2200mm
HEIGHT	2000mm
QTY	2

INSTALLATION: All sides: Eyelets

STADIUM



EXTERNAL

Presidents Plaza – Entrance Canopy



SPECIFICATIONS

MATERIAL	Breeze cloth banner or PVC Banner, keddar edge
WIDEST	8.75m
NARROWEST	3m
PERPENDICULAR	5m

INSTALLATION: Tracking & eyelets

EXTERNAL

Council/Vincent & Fairfax Stands



SPECIFICATIONS

MATERIAL	Breeze cloth banner
WIDTH	10m
HEIGHT	3.1m

INSTALLATION: Webbing & eyelets

EXTERNAL

Upper Rafter Banner – Sinclair Stand



SPECIFICATIONS

MATERIAL	Breeze cloth banner
WIDTH	10m
HEIGHT	3.1m

INSTALLATION: Webbing & eyelets

EXTERNAL

Martin & Angus Stand – Upper Rafter Banner



SPECIFICATIONS

MATERIAL	Breeze cloth banner
WIDTH	10m
HEIGHT	3.2m

INSTALLATION: Webbing & eyelets

EXTERNAL

Martin & Angus Stand – Upper Rectangle. Gate B



SPECIFICATIONS

MATERIAL	PVC banner
WIDTH	6m
HEIGHT	3m

INSTALLATION: Rope edge

EXTERNAL

Members Stand – Upper Rafter Banner



SPECIFICATIONS

MATERIAL	Breeze cloth banner
WIDTH	10m
HEIGHT	3.1m

INSTALLATION: Webbing & eyelets

INTERNAL
Stadium Internal Fence



SPECIFICATIONS

MATERIAL	Corflute
LENGTH	12m
HEIGHT	1.05m

NOTE: Signage can be in place with or without temporary seating.

INTERNAL
Members Stand – Upper/Tier Rectangle Banner

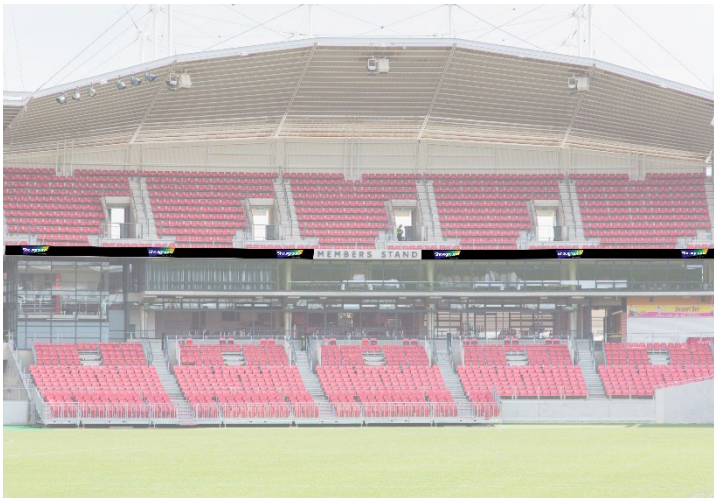

SPECIFICATIONS
LEFT HAND SIDE

MATERIAL	Corflute
LENGTH	20.6m
HEIGHT	0.58m

SPECIFICATIONS
RIGHT HAND SIDE

MATERIAL	Corflute
LENGTH	20.5m
HEIGHT	0.58m

INTERNAL

Sinclair Stand – Upper/Tier Rectangle Banner

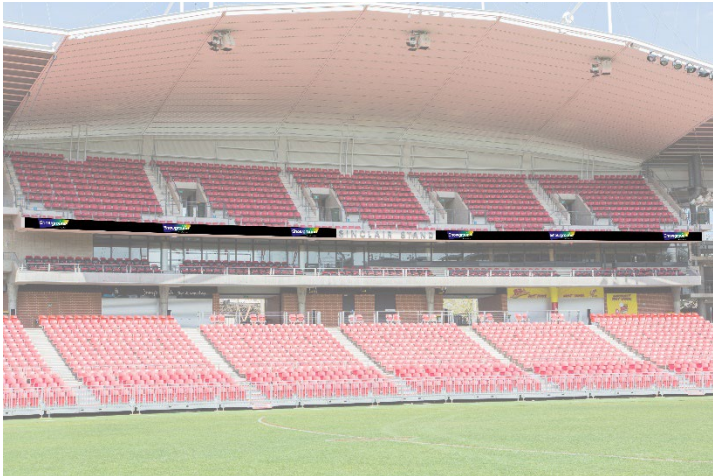

**SPECIFICATIONS
LEFT HAND SIDE**

MATERIAL	Corflute
LENGTH	20.65m
HEIGHT	0.58m

**SPECIFICATIONS
RIGHT HAND SIDE**

MATERIAL	Corflute
LENGTH	20.45m
HEIGHT	0.58m

INTERNAL

Suttor Stand – Upper/Tier Rectangle Banner

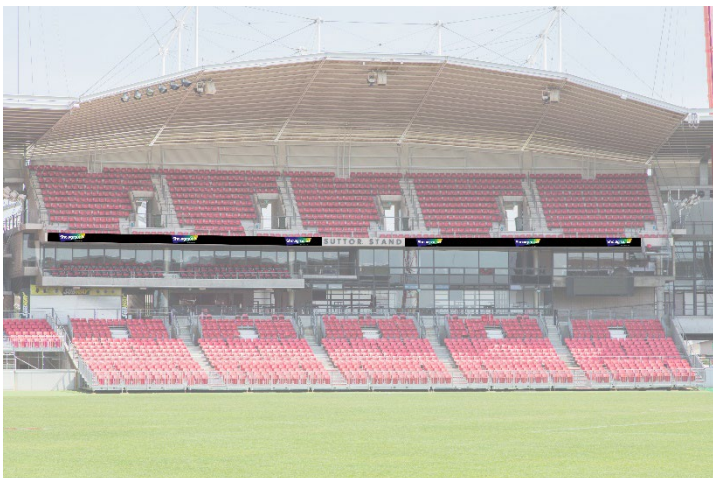

**SPECIFICATIONS
LEFT HAND SIDE**

MATERIAL	Corflute
LENGTH	29.3m
HEIGHT	0.58m

**SPECIFICATIONS
RIGHT HAND SIDE**

MATERIAL	Corflute
LENGTH	18.5m
HEIGHT	0.58m

INTERNAL

Vincent Fairfax Stand – Rectangle Banner

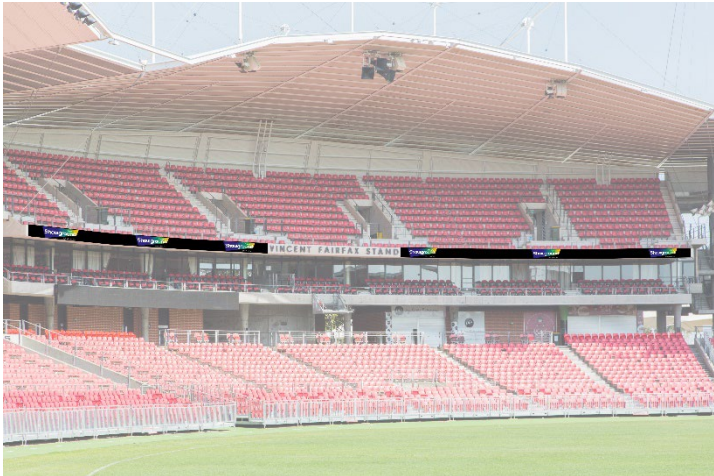

**SPECIFICATIONS
LEFT HAND SIDE**

MATERIAL	Corflute
LENGTH	21.5m
HEIGHT	0.58m

**SPECIFICATIONS
RIGHT HAND SIDE**

MATERIAL	Corflute
LENGTH	21.55m
HEIGHT	0.58m

INTERNAL

Martin & Angus Stand – Rectangle Banner

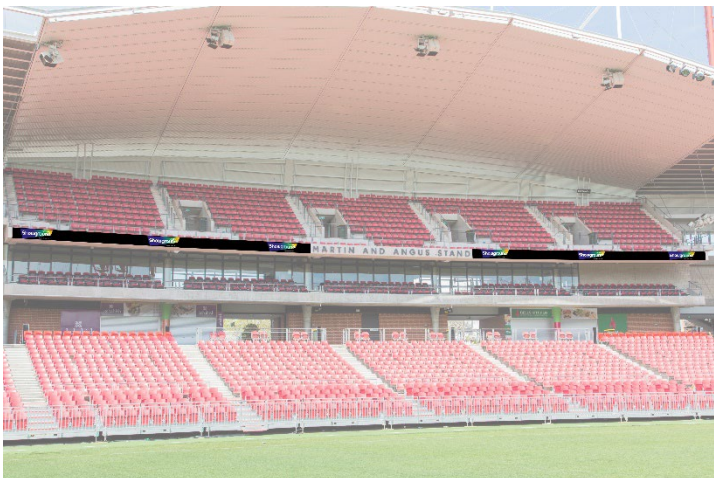

**SPECIFICATIONS
LEFT HAND SIDE**

MATERIAL	Corflute
LENGTH	46.5m
HEIGHT	0.58m

**SPECIFICATIONS
RIGHT HAND SIDE**

MATERIAL	Corflute
LENGTH	47.2m
HEIGHT	0.58m

INTERNAL

Sydney Royal Stand – Rectangle Banner



SPECIFICATIONS

MATERIAL	Corflute
LENGTH	45m
HEIGHT	0.7m

VOM 3 TUNNEL SIGNAGE

INTERNAL

Overhead Signage



SPECIFICATIONS
KEDDAR BANNER DIMENSIONS

MATERIAL	PVC Banner, Keddar Edge
WIDTH	9.08m
HEIGHT	4.93m

VOM 3 TUNNEL SIGNAGE

INTERNAL

Wall Banner



**SPECIFICATIONS
OVERALL DIMENSIONS**

MATERIAL	PVC Banner, Keddar Edge
SIDE A	1.58m
SIDE B	7.13m
SIDE C	4.09m

INTERNAL

Wall Banner



**SPECIFICATIONS
OVERALL DIMENSIONS**

MATERIAL	PVC Banner, Keddar Edge
SIDE A	6m
SIDE B	2.13m
SIDE C	2.26m

SCORE BOARD

EXTERNAL Side Panels

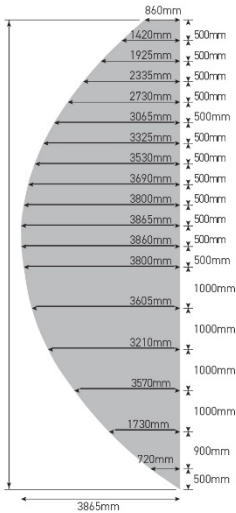

SPECIFICATIONS OVERALL DIMENSIONS

MATERIAL	Decal or similar
WIDTH	3.865m
HEIGHT	1.140m

INTERNAL Bottom Panel



SPECIFICATIONS CENTRE

WIDTH	2.03m
HEIGHT	1.615m

LEFT HAND SIDE

WIDTH	11.54m
HEIGHT	3.75m

RIGHT HAND SIDE

WIDTH	11.3m
HEIGHT	3.755m

DOOR

WIDTH	0.66m
HEIGHT	2m

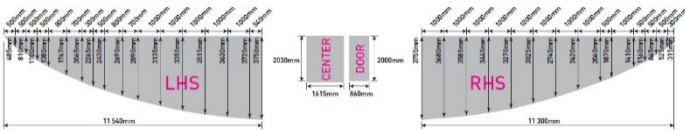

SYDNEY ROYAL STAND FOYERS

INTERNAL

Banners



SPECIFICATIONS
TRACK WIDTH

WIDTH	3m
-------	----

SPECIFICATIONS
BANNER DIMENSIONS

MATERIAL	PVC Banner
WIDTH	1.2m
HEIGHT	2.4m

SKYDECK
EXTERNAL
Left Return



SPECIFICATIONS

MATERIAL	3.5mm Di Bond Panel
WIDTH	3.375m
HEIGHT	0.602m

EXTERNAL
Left Return



SPECIFICATIONS

MATERIAL	3.5mm Di Bond Panel
WIDTH	10.820m
HEIGHT	0.602m

SKYDECK
EXTERNAL
Right Return



SPECIFICATIONS

MATERIAL	3.5mm Di Bond Panel
WIDTH	3.280m
HEIGHT	0.602m

CHARLEY ROOM

INTERNAL

Second Privacy Screen



SPECIFICATIONS OVERALL DIMENSIONS

WIDTH	2.4m
HEIGHT	2.55m

SPECIFICATIONS BANNER DIMENSIONS

MATERIAL	PVC Banner
WIDTH	1.13m
HEIGHT	2.4m

INTERNAL

Bathroom Banners



SPECIFICATIONS OVERALL DIMENSIONS

WIDTH	5.75m
HEIGHT	2.34m

SPECIFICATIONS BANNER DIMENSIONS

MATERIAL	PVC Banner
WIDTH	0.93m
HEIGHT	2.28m

CHARLEY ROOM
INTERNAL
Hanging Panels



SPECIFICATIONS
TRACK WIDTH

WIDTH	2.4m
-------	------

SPECIFICATIONS
PANEL DIMENSIONS

MATERIAL	PVC Banner
WIDTH	1.2m
HEIGHT	0.8m

CHANGE ROOM 1

INTERNAL

Hanging Panels

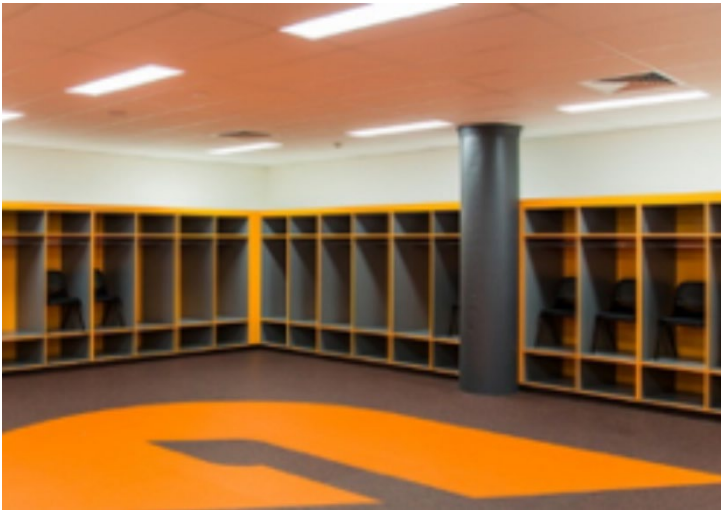

SPECIFICATIONS
TRACK WIDTH

WIDTH	2m
-------	----

SPECIFICATIONS
BANNER DIMENSIONS

MATERIAL	Corflute
WIDTH	2.4m
HEIGHT	1.2m

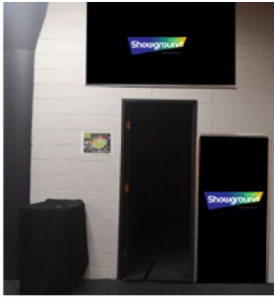
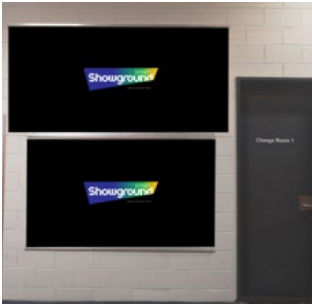

CHANGE ROOM 2

INTERNAL

Wall Banner - A



SPECIFICATIONS OVERALL DIMENSIONS

MATERIAL	Corflute
LENGTH	3.6m
HEIGHT	1.16m

INTERNAL

Wall Banner - B



SPECIFICATIONS OVERALL DIMENSIONS

MATERIAL	Corflute
LENGTH	Top left 4.63m Top right 4.18m Bottom 9.39m
HEIGHT	Top 1.16m Bottom 1.19m

INTERNAL

Wall Banner - C

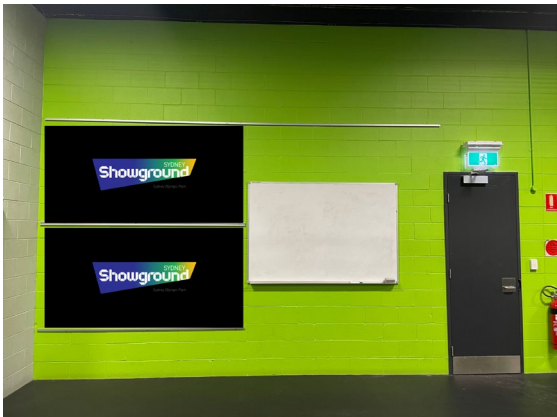

SPECIFICATIONS OVERALL DIMENSIONS

MATERIAL	Corflute
LENGTH	3.6m
HEIGHT	1.2m

CHANGE ROOM 2

INTERNAL

Wall Banner - D



SPECIFICATIONS OVERALL DIMENSIONS

MATERIAL	Corflute
LENGTH	3.75m
HEIGHT	1.16m

INTERNAL

Wall Banner - E



SPECIFICATIONS OVERALL DIMENSIONS

MATERIAL	Corflute
LENGTH	Top 9.7m Bottom 6.1m
HEIGHT	1.16m

CHANGE ROOM 2

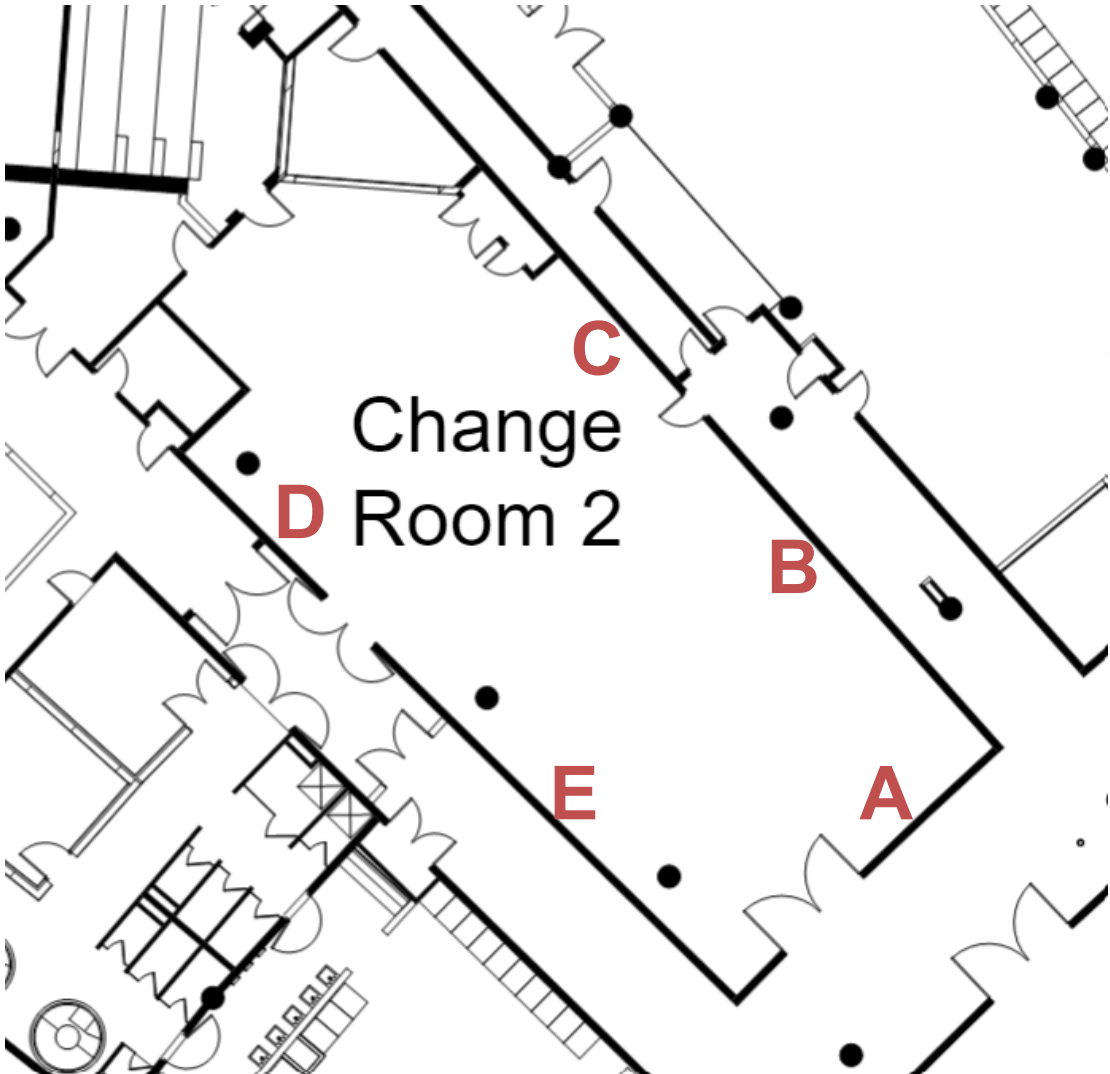

PRECINCT



EXTERNAL
Blade



SPECIFICATIONS

MATERIAL	3mm corflute
OVERALL	H3500mm x W900mm
FRONT	1220 x 900mm x 2 panels
BACK	1220 x 900mm x 2 panels
QTY	15
PRICE	\$66.00 per sign

EXTERNAL
Column – Medium Blade



SPECIFICATIONS

MATERIAL	3mm corflute
OVERALL	H2870mm x W600mm
PANEL 1 SIZE	910 x 590mm x 2 panels
PANEL 2 SIZE	910 x 590mm x 2 panels
QTY	10
PRICE	\$44.00 per sign

EXTERNAL
Showground Banners



SPECIFICATIONS

MATERIAL	Woven Polyester (1ge/sml)
LARGE	H5.3m x W0.94m
SMALL	H2.98m x W0.89m
PRICE	POA

Refer to SOPA Signage Guidelines for further information

EXTERNAL
Two-window Ticket Booth



SPECIFICATIONS

BETWEEN GLASS WINDOWS	H785mm x W450mm
ABOVE GLASS WINDOWS	H410mm x W1450mm

MAP
Flag pole locations



DIGITAL SIGNAGE



Extend Your Brand at your next Sydney Showground event

Sydney Showground have two prime locations where there is opportunity to display digital event signage or event branding; the exterior of the Dome entrance, and the interior Dome foyer.

Exterior Dome Entrance
3mm Transparent LED

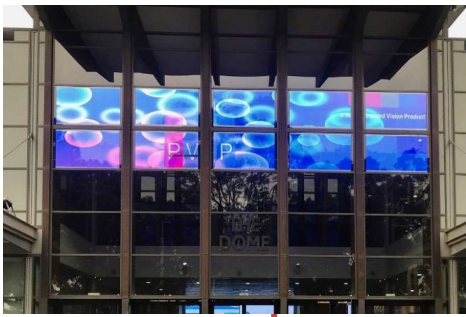

Interior Dome Foyer
2mm LED

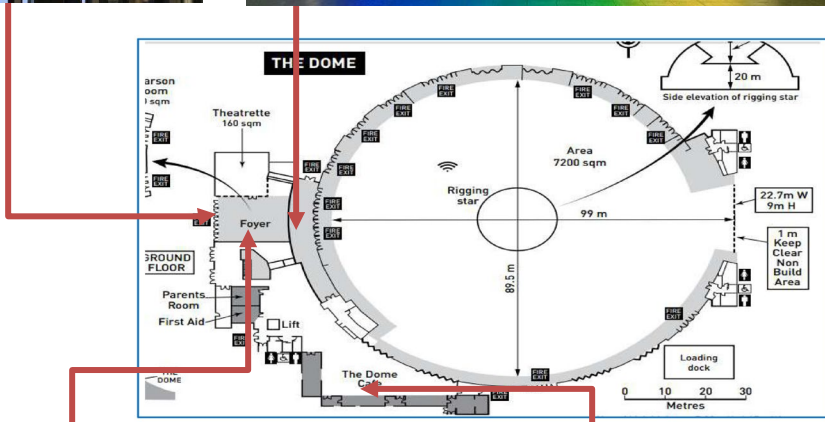

Dome Foyer

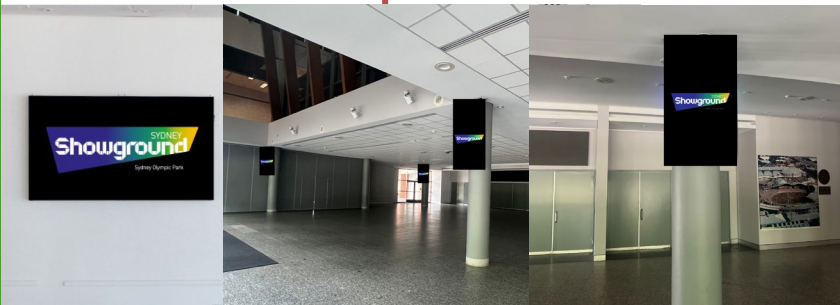

Dome Cafe



Introducing Sydney Showground Digital Screens. What a great way to extend your brand during your expo, or a great addition to your sponsorship suite (you can on-sell the screens to your customers or provide them as a value add).

Screen Locations

- Dome Foyer side wall 100% of time
- Dome entry doors 100% of time
- Dome Foyer pillars 100% of time
- Dome Café screens 50% of time
- (eg 30 seconds in every minute or 3 x 10 second blocks)
- All other screens 10 seconds or 16%+ of time
- 20 screens in total across the Dome and Halls.

Speak to your Account Manager or Event Representative for more details on how our digital signage solution can add value to your event.

Costs:

Interior Cafe screens	\$500
Dome Foyer pillar screens	\$500
Dome Foyer wall Screen	\$350
Interior Dome Foyer LED	\$500
Exterior Dome Entrance LED	\$1000
Dome Foyer Screen Package (includes 4 pillar screens, side wall and interior LED screen)	\$1000

All pricing is based per event.

Specifications – Dome Foyer & Cafes

Images
Portrait – JPEG, 1080x1920, 72dpi, RGB
Landscape – JPEG, 1920x1080, 72dpi, RGB

Animation
Flash - .swf

Movie
Windows Media Video - .wmv
Portrait 1080x1920, 25fps, 8000 bits
Landscape
1920x1080, 25fps, 8000 bits

Screen Zoning
When screen zoning is required – multiple playlists or media files on each screen, the area of 1920x1080 or 1080x1920 can be divided to whatever is required.

The media files associated to those zones should be created in the same aspect ratio as the area zoned.

For example: If you have a landscape screen with two zones, split down the middle, the resolution of each zone would be 960x1080.

The Dome Digital Signage – Technical Specifications

Exterior Dome LED Entrance 3mm Pitch, Transparent LED



10 x Individual Panels

Individual panel pixel size - 504 W x 256 H
Overall pixel size - 2520 W x 512 H Black/
dark gradient colours create the transparent effect
eg. 100% black = 100% transparent

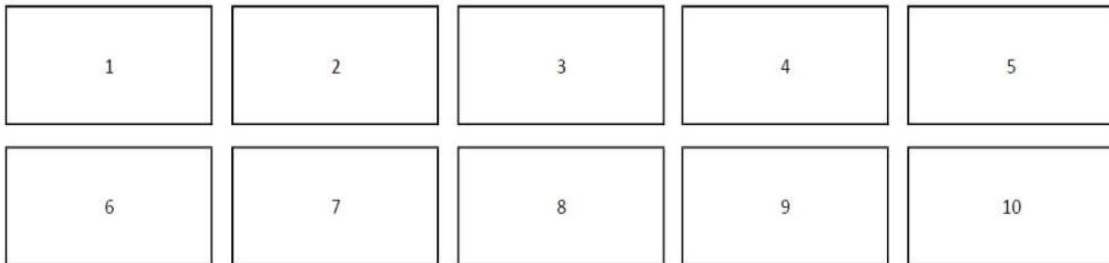

FILE	
VIDEO	.MP4 (H264) .AVI
STATIC	.JPEG .GIF .BMP .PNG

- Other file types may be possible, or may have to be converted to one of the above files types. Additional charges may be incurred.
- A sample file must be submitted 14 days before tenancy for testing purposes, and the final files 7 days before event commences.
- Should you not wish to utilise the Dome screens, Sydney Showground will display safety and venue messaging.

The Dome Digital Signage – Technical Specifications

Interior Dome LED Entrance

Overall pixel size - 3456 W x 384 H



FILE	
VIDEO	.MP4 (H264)
	.AVI
STATIC	.JPEG
	.GIF
	.BMP
	.PNG

- Other file types may be possible, or may have to be converted to one of the above files types. Additional charges may be incurred.
- A sample file must be submitted 14 days before tenancy for testing purposes, and the final files 7 days before event commences.
- Should you not wish to utilise the Dome screens, Sydney Showground will display safety and venue messaging.

Dome – Somerville & Pearson Screens

Pearson Room
65inch TV



Somerville Room
65inch TV

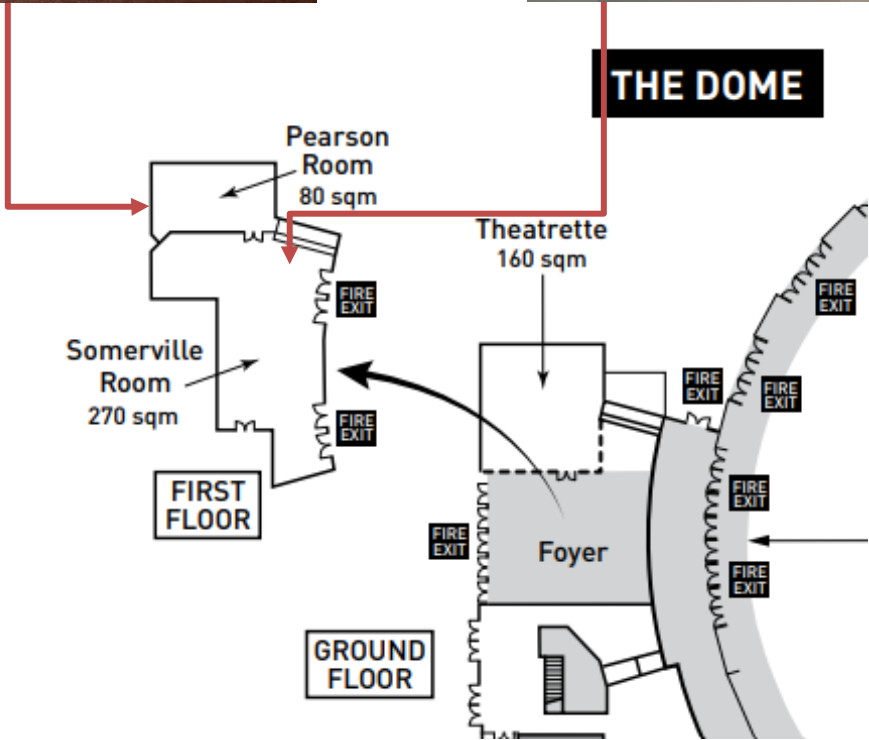

Dome – Somerville & Pearson Screens

Screen Locations

- Somerville & Pearson screens 100% of time, useful for presentations

Speak to your Account Manager or Event Representative for more details on how our digital signage solution can add value to your event.

Costs:

Somerville	\$200
Pearson	\$200

All pricing is based per event.

Specifications – Dome Foyer & Cafes

Images

Landscape – JPEG, 1920x1080, 72dpi, RGB

Animation

Flash - .swf

Movie

Windows Media Video - .wmv

Portrait 1080x1920, 25fps, 8000 bits

Landscape

1920x1080, 25fps, 8000 bits

ClickShare Technology

As part of the new digital signage system we have included ‘Clickshare’ on a number of monitors that enables wireless presentation to be undertaken direct from a laptop.

Each relevant monitor has a dongle plugged into a base station connected to the monitor which can be removed from the base station and inserted directly into a laptop that has a USB C port. Simply wait for it to ‘pair’ and off you go.

Any dongles damaged or lost will incur a replacement fee.

Halls 2 – 4 Screens

North Pod
65inch TV



South Pod
65inch TV

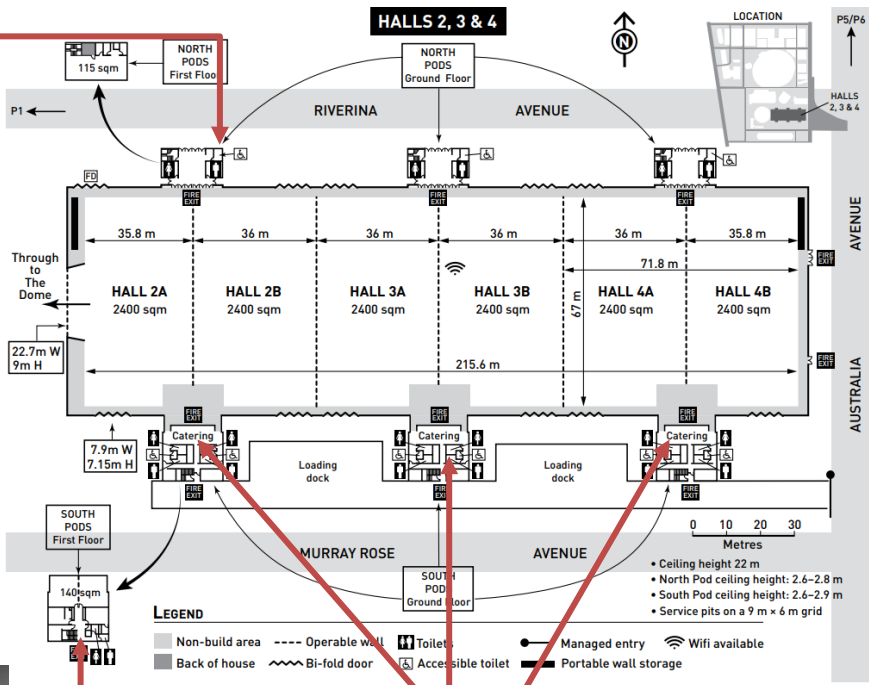

Hall Cafés
50inch TVs



Halls 2 – 4 Screens

Screen Locations

- Hall Café screens 50% of time
- (eg 30 seconds in every minute or 3 x 10 second blocks)
- North & South Pods 100% of time, useful for presentations

Speak to your Account Manager or Event Representative for more details on how our digital signage solution can add value to your event.

Costs:

Pod screens	\$200
Hall Café Screens (3 per cafe)	\$500

All pricing is based per event.

Specifications – Dome Foyer & Cafes

Images

Landscape – JPEG, 1920x1080, 72dpi, RGB

Animation

Flash - .swf

Movie

Windows Media Video - .wmv

Portrait 1080x1920, 25fps, 8000 bits

Landscape

1920x1080, 25fps, 8000 bits

ClickShare Technology

As part of the new digital signage system we have included ‘Clickshare’ on a number of monitors that enables wireless presentation to be undertaken direct from a laptop.

Each relevant monitor has a dongle plugged into a base station connected to the monitor which can be removed from the base station and inserted directly into a laptop that has a USB C port. Simply wait for it to ‘pair’ and off you go.

Any dongles damaged or lost will incur a replacement fee.

Halls 5 & 6 Screens

Hall 5 Foyer
55inch TV



Function Room 5
75inch TV

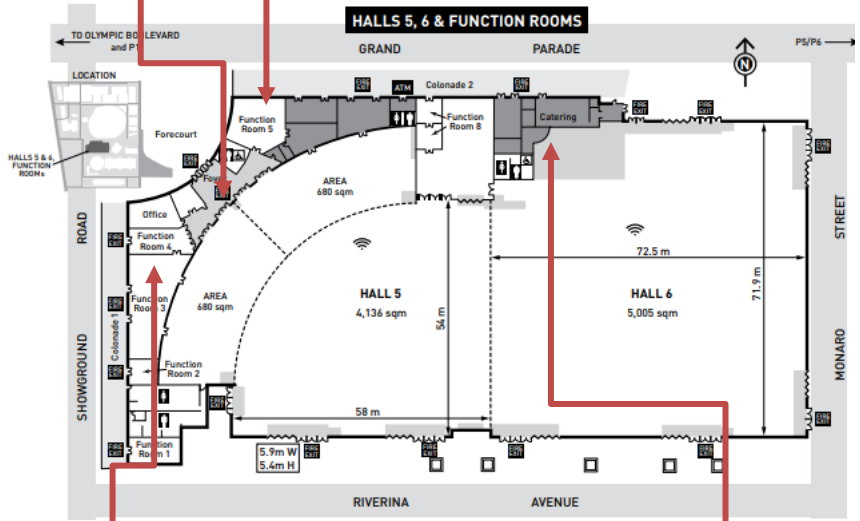

Function Room 3
75inch TV

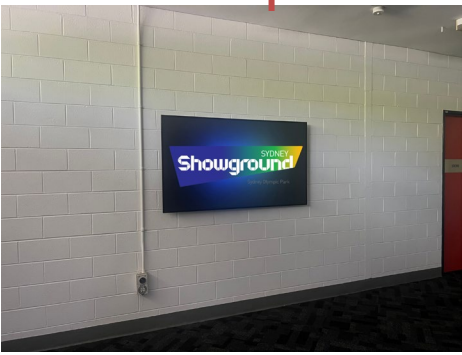

Hall 6 Café
75inch TV

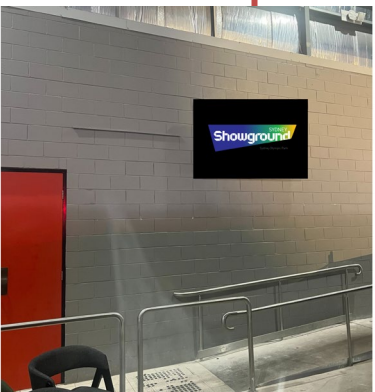

Halls 5 & 6 Screens

Screen Locations

- Hall 5 Foyer 100% of time
- Hall 6 Café screens 50% of time
- (eg 30 seconds in every minute or 3 x 10 second blocks)
- Function Rooms 3 & 5 100% of time, useful for presentations

Speak to your Account Manager or Event Representative for more details on how our digital signage solution can add value to your event.

Costs:

Hall 5 Foyer screen	\$200
Function Room screens	\$200
Hall 6 Café Screen	\$250

All pricing is based per event.

Specifications – Dome Foyer & Cafes

Images

Landscape – JPEG, 1920x1080, 72dpi, RGB

Animation

Flash - .swf

Movie

Windows Media Video - .wmv

Portrait 1080x1920, 25fps, 8000 bits

Landscape

1920x1080, 25fps, 8000 bits

ClickShare Technology

As part of the new digital signage system we have included ‘Clickshare’ on a number of monitors that enables wireless presentation to be undertaken direct from a laptop.

Each relevant monitor has a dongle plugged into a base station connected to the monitor which can be removed from the base station and inserted directly into a laptop that has a USB C port. Simply wait for it to ‘pair’ and off you go.

Any dongles damaged or lost will incur a replacement fee.

Mobile LED Screen

If you'd like to enhance your marketing campaign with some affordable outdoor advertising, this new portable digital screen could be just what you're after.

Costs:

\$1000 per day

\$2000 per week

KEY FEATURES

- 6mm pixel LED 9 providing a sharp clear image –ensuring your message is easy to read
- Built in video processor allowing playback through USB - simply plug in your USB and away it goes.(Also has DVI or HDMI input for ease of use)
- 100 watts PA system with external speakers – get your message out loud and clear



SPECIAL CONDITIONS

- Bookings are on a first in first served basis
- If already pre-booked, and the organisation who has booked it agrees, the screen can be shared on a 50/50 rotational basis between two customers at 50% of the cost per customer
- On board DVD Player – play your promotional video for even more impact
- On board digital set top box allowing free to air Digital TV reception
- Silent generator for position anywhere on site (or plug in where available)
- PowerPoint format only
- On the occasion that the mobile digital sign is needed to direct visitors to an event this 'Directional Signage' will take priority over 'Marketing Promotion' use (directional signage use is FOC and at the discretion of the venue depending on event loads and requirements)

Stadium Level 2 Parapet

Video

LED
1600W x 72H



LED
1040W x 72H



LED
720W x 72H



VIDEO

PIXEL DIMENSIONS	1040 x 72px 720 x 72px
ANIMATION DURATION	30 seconds
FRAMES PER SECOND	30 (FPS) Use the whole stage as there is no safe zone

We recommend using video versus static images. The movement/animation in video provides a higher impact and engagement with fans.

SIGNAGE REQUIREMENTS



Sydney Showground Minimum Requirements for Signage

- 1. Minimum Manufacturing Requirements** The minimum manufacturing requirements are:
 - I. Load:
 - a. Top pocket or eyelets – 14kg per lineal metre of the width plus the weight of banner.
 - b. Bottom pocket – 14kg per lineal metre of the width of the banner.
 - II. Pockets to be hot air welded and stitched.
 - III. Eyelets to be reinforced (webbing affixed).

Please ensure that all manufacturers undertaking Sydney Showground work through you are made aware of these minimum manufacturing requirements and provide a Quality Assurance Statement from the supplier/manufacture stating that any newly produced signage meets or exceeds the standards outlined within the minimum manufacturing requirements and therefore is fit for purpose.

- 2. Minimum Rigging and De-Rigging Requirements** Any banner requiring hanging at a height above 2.4m must be rigged by the Sydney Showground authorised rigger.

Sydney Showground has a large rigging capacity within the Exhibition Halls & Secondary Pavilions; detailed plans are available on request. Rigging plans must be submitted to the Sydney Showground to review two weeks prior to the licence period commencing.

Rigging within Sydney Showground’s secondary pavilions must be signed off by a certified structural engineer.

- 3. Minimum Installation Requirements**

At all times the presentation standards of the Sydney Showground along with best practise installation methods are to be upheld.

The Sydney Showground does not permit the sticking, posting, hanging or attaching of any signage, notices, banners or advertisements on ceilings, floors, walls, walkways, railings, fences or any property belonging to the Sydney Showground without prior written approval. Any fixing items used must not damage Sydney Showground property. The cost of repair due to damage sustained from the use of nonapproved fixing agents will be borne by the Signage Installation company. Any damage caused will be charged back to the licensee.

Should a sign be affixed to a temporary structure or frame, the structure or frame must abide by the New South Wales, State Legislative Requirements as set out in the “State Environmental Planning Policy (Temporary Structures and Places of Public Entertainment) Amendment (Temporary Structures)– 2009” and be signed off by a certified structural engineer supplied by the Contractor responsible for the installation of the sign. Upon approval, an engineer’s certificate must be provided to the Sydney Showground Signage Coordinator.

Site Wide Signage

Sydney Showground will seek permission on the licensee’s behalf for any signage placed outside the Sydney Showground site from the local authority. This includes signage or banners placed on any fenceline that faces a roadway.

Promotional Signage

Promotional signage may be displayed only within the licensee’s immediate licensed area. Permission and approval of all promotional signage is required prior to being displayed. Signage on site takes into consideration ALL events that are operational at any one time. The decision on how signage space is allocated is at the discretion of Sydney Showground.

Naming

Naming Protocol

The correct naming of the venue is:

Sydney Showground at Sydney Olympic Park

Sydney Showground is the venue and Sydney Olympic Park is the suburb. Under no circumstances are the words 'Homebush' or 'Homebush Bay' to be used on any print or digital signage or other marketing collateral including TV commercials and radio announcements.

Correct naming will ensure that your customers know exactly where to find the venue and your event. Use of incorrect suburb names can lead to confusion including customers getting off at the wrong train station or driving to the wrong suburb.

Please ensure final proof of signage is sent to your Event Planner prior to printing.



1 Showground Road, Sydney Olympic Park, NSW 2127 Australia
Phone +61 2 9704 1157 Email sales@sydneyshowground.com.au
www.sydneyshowground.com.au