

OPERATIONAL REGULATIONS

SIGNAGE COMPENDIUM



Contents

| | |
|-------------------------------------|-----------|
| <u>DOME</u> | 3 |
| External | |
| <u>EXHIBITION HALLS</u> | 8 |
| External | |
| Internal | |
| North Pod | |
| South Pod | |
| Halls 5 & 6 | |
| <u>CHARLES MOSES STADIUM</u> | 19 |
| External | |
| Internal | |
| <u>PAVILIONS</u> | 23 |
| Downes | |
| Falkiner | |
| Grace | |
| Mackay | |
| Munro | |
| Murchison | |
| Paddington | |
| Howie | |
| <u>STADIUM</u> | 28 |
| External | |
| Scoreboard | 31 |
| Stadium Ticket box | 32 |
| Internal | |
| Vom 3 Tunnel | 36 |
| Sydney Royal Stand Foyers | 38 |
| Skydeck | 39 |
| Charley Room | 40 |
| Change Room 1 | 43 |
| Change Room 2 | 44 |
| <u>PRECINCT</u> | 48 |
| External | |
| <u>DIGITAL SIGNAGE</u> | 52 |
| <u>SIGNAGE REQUIREMENTS</u> | 64 |

DOME



EXTERNAL

Dome Entrance Foyer



| LARGE BANNER | | | |
|--------------|---------|--------|-----|
| MATERIAL | WIDTH | HEIGHT | QTY |
| PVC | 12400mm | 5150mm | 1 |

| SMALL BANNER | | | |
|--------------|--------|--------|-----|
| MATERIAL | WIDTH | HEIGHT | QTY |
| PVC | 7500mm | 4500mm | 1 |

INSTALLATION: Catenary Wire installation. Refer to rigging company for engineering.

EXTERNAL

Wall Banner



| WALL BANNER | |
|-------------|--------|
| MATERIAL | PVC |
| WIDTH | 5070mm |
| HEIGHT | 3550mm |
| QTY | 6 |

INSTALLATION: Top: Eyelets
Bottom: Rope edge





EXTERNAL
Dome Entrance Foyer



WINDOW DECALS

| | |
|----------|--|
| MATERIAL | Decal |
| WIDTH | 1 - 6 – 2130mm |
| HEIGHT | 1, 4 – 1080mm 2, 3 – 1130mm 5 – 1110mm 6 – 1490mm |

Mullions

| | |
|----------|--|
| MATERIAL | NA |
| WIDTH | A – 200mm  B – 360mm  |
| HEIGHT | C – 50mm  D – 120mm  |

EXTERNAL
Dome Entrance Foyer



| WINDOW DECALS | |
|---------------|--|
| MATERIAL | Decal |
| WIDTH | 1, 2, 3 – 1050mm 4, 5, 6 – 650mm |
| HEIGHT | 1, 6 – 1110mm 2, 5 – 1140mm 3, 4 – 650mm |

EXTERNAL

Dome Ticket Box



| WINDOW DECALS | |
|---------------|---|
| MATERIAL | Decal |
| WIDTH | 1 – 1825mm 2 – 1760mm 3 – 420mm 4 – 540mm 5 – 485mm |
| HEIGHT | 1, 2 – 1140mm 3 – 425mm 4, 5 – 1020mm |

EXHIBITION HALLS



EXTERNAL

Dome Entrance Foyer



SPECIFICATIONS

| | |
|----------|--------------|
| MATERIAL | PVC |
| WIDTH | 9630mm |
| HEIGHT | 3600mm |
| QTY | 2 (per hall) |

INSTALLATION: All sides: Eyelets

EXTERNAL

External Foyer Wall



SPECIFICATIONS

| | |
|----------|--------------|
| MATERIAL | PVC |
| WIDTH | 2300mm |
| HEIGHT | 2300mm |
| QTY | 2 (per hall) |

EXTERNAL Side Triangle

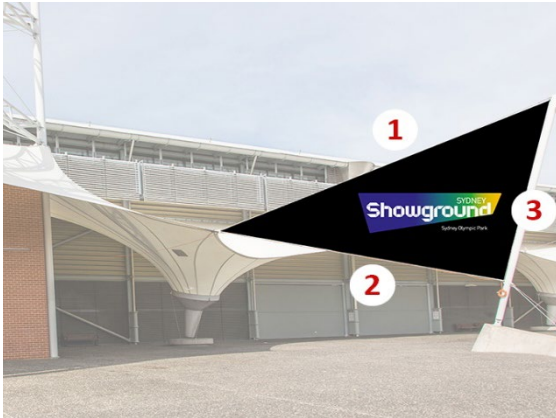

SPECIFICATIONS

| MATERIAL | SIDE 1 | SIDE 2 | SIDE 3 | QTY |
|----------|---------|---------|--------|--------------|
| PVC | 12150mm | 10030mm | 6750mm | 2 (per hall) |

SQUARED OFF CORNERS

| SIDE 1-2 | SIDE 1-3 | QTY |
|-----------|-----------|-----|
| 120mm (W) | 250mm (W) | 2 |

INSTALLATION: All sides: PVC Banner, Eyelets All Sides

EXTERNAL Side Triangle



SPECIFICATIONS

| MATERIAL | PVC |
|----------|--------------|
| SIDE 1 | 8100mm |
| SIDE 2 | 8100mm |
| SIDE 3 | 4000mm |
| QTY | 2 (per hall) |

INSTALLATION: All sides: Eyelets

INTERNAL

Internal Pod Signage (Hall 2 - 4)



NORTH PODS LEVEL 2 INTERNAL WINDOWS LHS & RHS

| | |
|-------------|-----------------------|
| TOP HALF | W 1650 x H 950mm |
| BOTTOM HALF | W 1650 x H 1130mm |
| MATERIAL | Banner/Corflute/Decal |

INTERNAL

North Pod – Level 2 Front Window



NORTH POD LEVEL 2 FRONT WINDOW

| | |
|-------------|-----------------------|
| TOP HALF | W 2200 x H 1100mm |
| BOTTOM HALF | W 2200 x H 1100mm |
| MATERIAL | Banner/Corflute/Decal |

INTERNAL

North Pod Foyer



DOORS X 2

| | |
|--------|--------|
| WIDTH | 4800mm |
| HEIGHT | 560mm |

SIDE OF WALL FOYER

| | |
|--------|--------|
| WIDTH | 2400mm |
| HEIGHT | 1200mm |

INTERNAL

South Pods – Level 2



SOUTH PODS LEVEL 2

INTERNAL WINDOWS LHS & RHS

| | |
|-------------|-----------------------|
| TOP HALF | W 1650 x H 950mm |
| BOTTOM HALF | W 1650 x H 1130mm |
| MATERIAL | Banner/Corflute/Decal |

INTERNAL
South Pod – Level 2 Front Window



| SOUTH POD LEVEL 2 FRONT WINDOW | |
|-----------------------------------|-----------------------|
| TOP HALF | W 2200 x H 1100mm |
| BOTTOM HALF | W 2200 x H 1100mm |
| MATERIAL | Banner/Corflute/Decal |

EXTERNAL
Hall 5A Function Room 3 Entry



| HALL 5A FUNCTION ROOM 3 ENTRY SHOWGROUND RD | |
|--|----------------------|
| DIMENSIONS | 5820 X 4000 x 2100mm |
| MATERIAL | PVC Corner Eyelets |

LOCATION: Showground Rd – Outside
Southee 3

EXTERNAL

Hall 5A Main Entry Foyer – Right Hand Side



**HALL 5A MAIN ENTRY FOYER
RIGHT HAND SIDE**

| | |
|------------|--------------------|
| DIMENSIONS | W 20070 x H 1300mm |
| MATERIAL | PVC Track Mounted |

INSTALLATION: Sail track on top deck and eyelets on the bottom.

LOCATION: Corner of Grand Pde & Showground Rd existing Southee Complex Entry point

EXTERNAL

Hall 5A Main Entry Foyer – Left Hand Side



**HALL 5A MAIN ENTRY FOYER
LEFT HAND SIDE**

| | |
|------------|--------------------|
| DIMENSIONS | W 15500 x H 1300mm |
| MATERIAL | PVC Track Mounted |

INSTALLATION: Sail track on top deck and eyelets on the bottom.

LOCATION: Corner of Grand Pde & Showground Rd existing Southee Complex Entry point

EXTERNAL
Hall 5A Main Entry Foyer - Doors



| HALL 5A MAIN ENTRY FOYER DOORS | |
|--------------------------------|--|
| DIMENSIONS | A - W 240 x H 3100mm B - W 2070 x H 450mm C - W 910 x H 2470mm |
| MATERIAL | Decal |

EXTERNAL
Halls 5 & 6 – Window Banners



| HALLS 5 & 6 – RIVERINA AVE ENTRY DOORS | |
|--|--|
| DIMENSIONS | W 7340 x 2735mm |
| MATERIAL | Fabric Stretch, with silicon edge Existing frame is in place |

LOCATION: Riverina Side of Halls 5 & 6
(Above Entry Doors)

EXTERNAL Halls 5 & 6 – Riverina Ave



LOCATION: Riverina Side of Halls 5 & 6
(Above Entry Doors)

HALLS 5 & 6 – RIVERINA AVE ENTRY DOORS

MATERIAL Corflute

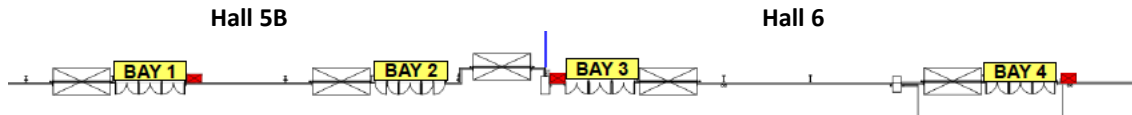

HALLS 5 & 6 – RIVERINA AVE ENTRY DOORS

| | 1 | 2 | 3 | 4 | 5 | 6 |
|-------|-------------------------|-------------------------|-------------------------|-------------------------|------------------------|-------------------------|
| Bay 1 | W 1200mm x H 2640 mm | W 1190mm x H 2640mm | W 1200mm x H 2640 mm | W 1200mm x H 2640 mm | W 1190mm x H 2640mm | W 1180mm x H 2640 mm |
| Bay 2 | W 1180mm x H 2640 mm | W 1190mm x H 2640mm | W 1200mm x H 2640 mm | W 1200mm x H 2640 mm | W 1190mm x H 2640mm | W 1180mm x H 2640 mm |
| Bay 3 | W 1185mm x H 2640mm | W 1180mm x H 2640 mm | W 1200mm x H 2640 mm | W 1200mm x H 2640 mm | W 1185mm x H 2640mm | W 1195mm x H 2640mm |
| Bay 4 | W 1205mm x H 2640mm | W 1185mm x H 2640mm | W 1200mm x H 2640 mm | W 1200mm x H 2640 mm | W 1190mm x H 2640mm | W 1175mm x H 2640mm |

All of the width measurements have had 10mm deducted so the signage will be easily installable. The tracking runs vertical and measures 65mm in width, the tracking is a H mold design. The signage sheets will sit in 22mm inside the H mold channel each side with 5mm clearance each side.

EXTERNAL

Halls 5 & 6 – Riverina Ave



HALLS 5 & 6 – RIVERINA AVE BANNER LOCATION

| | |
|------------|---------------------------------------|
| DIMENSIONS | W 4800 x H 9000mm Top Width 4000mm |
| MATERIAL | PVC / Mesh Banner with eyelets |

LOCATION: Riverina Side of Halls 5 & 6 (2 Banner Points)

INTERNAL

Halls 5A Foyer



HALLS 5A Foyer SIDE WALLS OF FOYER

| | |
|------------|---------------------------------------|
| DIMENSIONS | H 2500 X H 6000 (to 3phase outlet) |
| MATERIAL | PVC Banner |

LOCATION: Entry way of Hall 5A Foyer

INTERNAL

Hall 5A Foyer



HALL 5A FOYER

ABOVE ENTRY DOORS TO HALL 5A

| | |
|------------|----------------|
| DIMENSIONS | H 720 X W 4100 |
| MATERIAL | 3mm Corflute |

LOCATION: Above entry doors in Hall 5A foyer entering Hall 5A

INTERNAL

Halls 5 & 6 – Rigging Opportunities



HALLS 5 & 6 – RIVERINA AVE

2 BANNER POINTS

| |
|-------------------------|
| Custom Rigging Internal |
| Example only |

LOCATION: Custom Rigging Internal – Example only

CHARLES MOSES STADIUM



SIGNAGE COMPENDIUM

CHARLES MOSES STADIUM

EXTERNAL

Charles Moses Entry Square



SPECIFICATIONS

| | |
|----------|--------|
| MATERIAL | PVC |
| WIDTH | 2200mm |
| HEIGHT | 2200mm |
| QTY | 1 |

INSTALLATION: All sides: Eyelets

EXTERNAL

Charles Moses Entry Banner

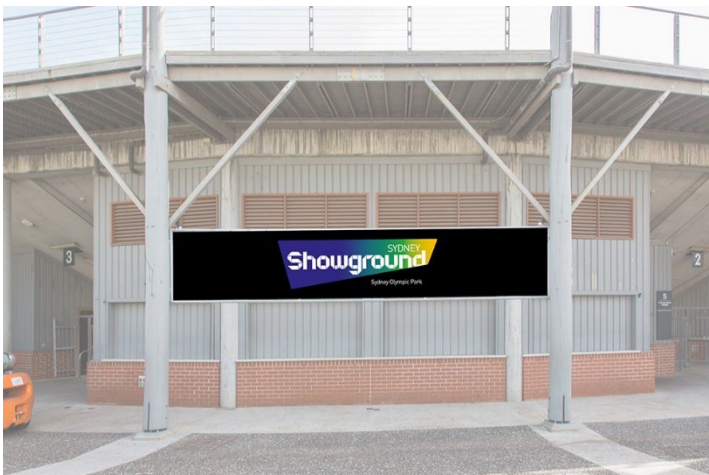

SPECIFICATIONS

| | |
|----------|--------|
| MATERIAL | PVC |
| WIDTH | 6600mm |
| HEIGHT | 2000mm |
| QTY | 1 |

SIGNAGE COMPENDIUM CHARLES MOSES STADIUM

INTERNAL Balustrade - Side



SPECIFICATIONS

| | |
|----------|--------|
| MATERIAL | PVC |
| WIDTH | 7300mm |
| HEIGHT | 850mm |
| QTY | 2 |

INSTALLATION: All sides: Eyelets

INTERNAL Balustrade - Front



SPECIFICATIONS

| | |
|----------|--------|
| MATERIAL | PVC |
| WIDTH | 8000mm |
| HEIGHT | 1000mm |
| QTY | 1 |

SIGNAGE COMPENDIUM CHARLES MOSES STADIUM

INSTALLATION: All sides: Eyelets

INTERNAL

Gantry Signage

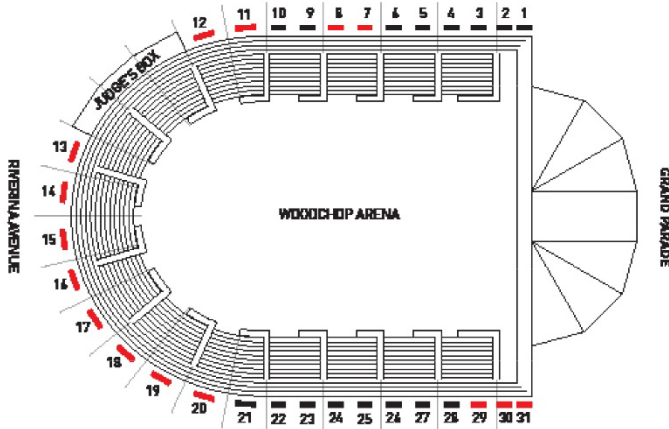

Gantry Signage Internal LHS



Gantry Signage Internal LHS

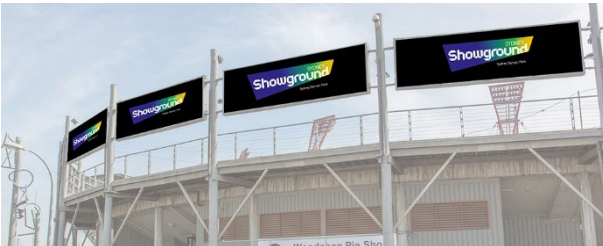

SITES

| | |
|---------|--------------|
| SITE 1 | 2.53m x 1.8m |
| SITE 2 | 2.44m x 1.8m |
| SITE 3 | 3.87m x 1.8m |
| SITE 4 | 3.87m x 1.8m |
| SITE 5 | 3.83m x 1.8m |
| SITE 6 | 3.8m x 1.8m |
| SITE 7 | 3.85m x 1.8m |
| SITE 8 | 3.95m x 1.8m |
| SITE 9 | 3.86m x 1.8m |
| SITE 10 | 3.86m x 1.8m |
| SITE 11 | 4.95m x 1.8m |
| SITE 12 | 5.6m x 1.8m |
| SITE 13 | 5.77m x 1.8m |
| SITE 14 | 5.9m x 1.8m |
| SITE 15 | 6.01m x 1.8m |
| SITE 16 | 6.01m x 1.8m |
| SITE 17 | 5.95m x 1.8m |
| SITE 18 | 6.0m x 1.8m |
| SITE 19 | 5.98m x 1.8m |
| SITE 20 | 5.94m x 1.8m |
| SITE 21 | 4.96m x 1.8m |
| SITE 22 | 3.91m x 1.8m |
| SITE 23 | 3.81m x 1.8m |
| SITE 24 | 3.92m x 1.8m |
| SITE 25 | 3.81m x 1.8m |
| SITE 26 | 3.9m x 1.8m |
| SITE 27 | 3.86m x 1.8m |
| SITE 28 | 3.81m x 1.8m |
| SITE 29 | 3.87m x 1.8m |
| SITE 30 | 2.51m x 1.8m |
| SITE 31 | 2.48m x 1.8m |

PAVILIONS



EXTERNAL

Downes Pavilion



| SPECIFICATIONS | |
|----------------|--------|
| MATERIAL | PVC |
| WIDTH | 6600mm |
| HEIGHT | 2000mm |
| QTY | 3 |

EXTERNAL

Falkiner Pavilion



| SPECIFICATIONS | |
|----------------|--------|
| MATERIAL | PVC |
| WIDTH | 6600mm |
| HEIGHT | 2000mm |
| QTY | 2 |

INSTALLATION: All sides: Eyelets

EXTERNAL Grace Pavilion



SPECIFICATIONS

| | |
|----------|--------|
| MATERIAL | PVC |
| WIDTH | 6600mm |
| HEIGHT | 2000mm |
| QTY | 1 |

INSTALLATION: All sides: Eyelets

EXTERNAL Mackay Pavilion



SPECIFICATIONS

| | |
|----------|--------|
| MATERIAL | PVC |
| WIDTH | 6600mm |
| HEIGHT | 2000mm |
| QTY | 1 |

INSTALLATION: All sides: Eyelets

EXTERNAL Munro Pavilion



| SPECIFICATIONS | |
|----------------|--------|
| MATERIAL | PVC |
| WIDTH | 6600mm |
| HEIGHT | 2000mm |
| QTY | 3 |

EXTERNAL Murchison Pavilion



| SPECIFICATIONS | |
|----------------|--------|
| MATERIAL | PVC |
| WIDTH | 6600mm |
| HEIGHT | 2000mm |
| QTY | 4 |

INSTALLATION: All sides: Rope edge

EXTERNAL Paddington Pavilion



SPECIFICATIONS

| | |
|----------|--------|
| MATERIAL | PVC |
| WIDTH | 6600mm |
| HEIGHT | 2000mm |
| QTY | 1 |

INSTALLATION: All sides: Eyelets

EXTERNAL Howie Pavilion

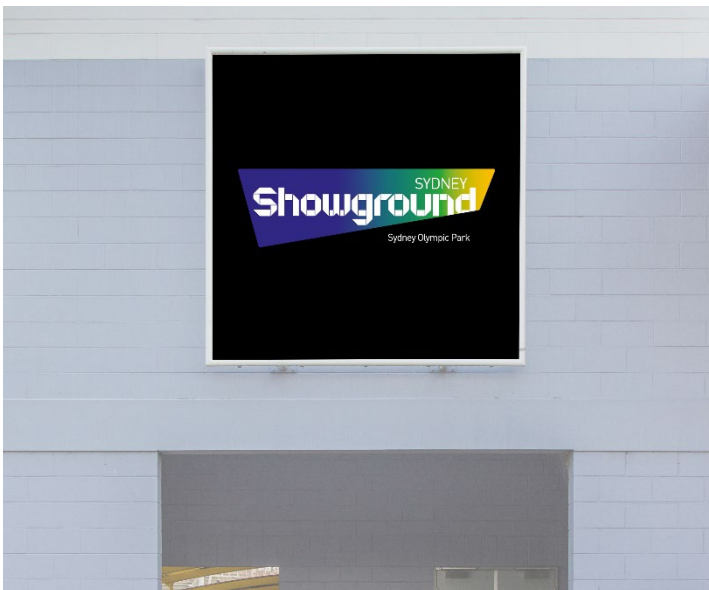

SPECIFICATIONS

| | |
|----------|--------|
| MATERIAL | PVC |
| WIDTH | 2200mm |
| HEIGHT | 2000mm |
| QTY | 2 |

INSTALLATION: All sides: Eyelets

STADIUM



EXTERNAL
Presidents Plaza – Entrance Canopy



SPECIFICATIONS

| | |
|---------------|--|
| MATERIAL | Breeze cloth banner or PVC Banner, keddar edge |
| WIDEST | 8.75m |
| NARROWEST | 3m |
| PERPENDICULAR | 5m |

INSTALLATION: Tracking & eyelets

EXTERNAL
Council/Vincent & Fairfax Stands



SPECIFICATIONS

| | |
|----------|---------------------|
| MATERIAL | Breeze cloth banner |
| WIDTH | 10m |
| HEIGHT | 3.1m |

INSTALLATION: Webbing & eyelets

EXTERNAL

Upper Rafter Banner – Sinclair Stand

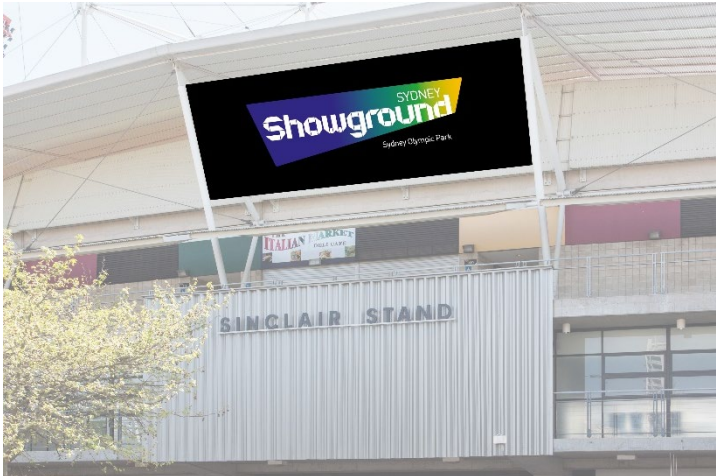

| SPECIFICATIONS | |
|----------------|---------------------|
| MATERIAL | Breeze cloth banner |
| WIDTH | 10m |
| HEIGHT | 3.1m |

INSTALLATION: Webbing & eyelets

EXTERNAL

Martin & Angus Stand – Upper Rafter Banner



| SPECIFICATIONS | |
|----------------|---------------------|
| MATERIAL | Breeze cloth banner |
| WIDTH | 10m |
| HEIGHT | 3.2m |

INSTALLATION: Webbing & eyelets

EXTERNAL

Martin & Angus Stand – Upper Rectangle. Gate B



SPECIFICATIONS

| | |
|----------|------------|
| MATERIAL | PVC banner |
| WIDTH | 6m |
| HEIGHT | 3m |

INSTALLATION: Rope edge

EXTERNAL

Members Stand – Upper Rafter Banner



SPECIFICATIONS

| | |
|----------|---------------------|
| MATERIAL | Breeze cloth banner |
| WIDTH | 10m |
| HEIGHT | 3.1m |

INSTALLATION: Webbing & eyelets

SIGNAGE COMPENDIUM STADIUM

SCORE BOARD

EXTERNAL

Top Panel



SPECIFICATIONS

OVERALL

| | |
|----------|---------------------------------------|
| MATERIAL | Fabric Banner with reinforced webbing |
|----------|---------------------------------------|

SPECIFICATIONS

TOP*

| | |
|--------|--------|
| WIDTH | 25.76m |
| HEIGHT | 3.59m |

*Naming rights exclusive

Side Panels



SPECIFICATIONS

LEFT & RIGHT SIDE*

| | |
|--------|--------|
| WIDTH | 3.63m |
| HEIGHT | 11.41m |

*Subject to venue approval

Bottom Panels



LEFT & RIGHT BOTTOM*

| | |
|--------|--------|
| WIDTH | 11.05m |
| HEIGHT | 3.24m |

*Subject to venue approval

INSTALLATION: Kedder inside edge with eyelets every 500mm along curve. Stainless steel cable ties to secure SS strap eyes on outer return

STADIUM TICKET BOX

EXTERNAL

Window panels – top row only



| SPECIFICATIONS | |
|------------------|-------|
| PANEL DIMENSIONS | |
| MATERIAL | Decal |
| WIDTH | 700mm |
| HEIGHT | 510mm |

INTERNAL Stadium Internal Fence

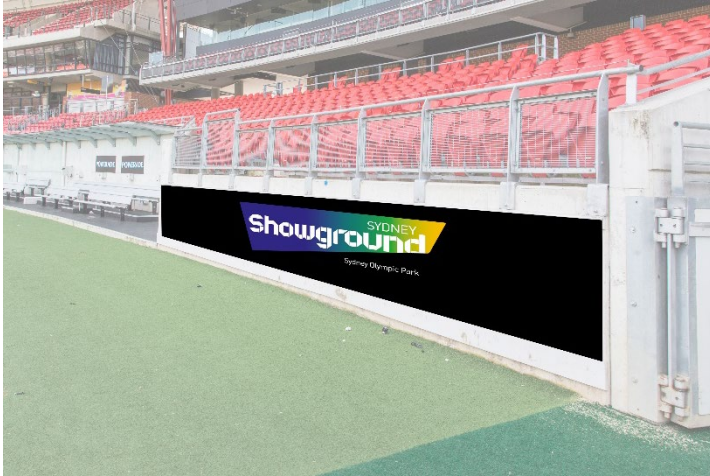

SPECIFICATIONS

| | |
|----------|----------|
| MATERIAL | Corflute |
| LENGTH | 12m |
| HEIGHT | 1.05m |

NOTE: Signage can be in place with or without temporary seating.

INTERNAL Members Stand – Upper/Tier Rectangle Banner

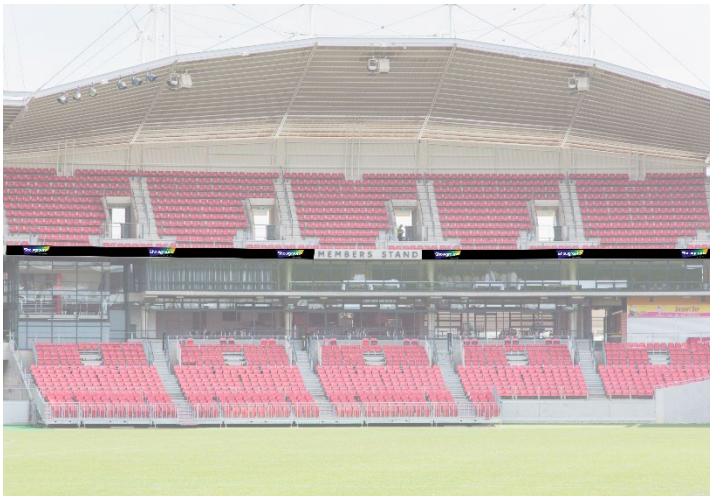

SPECIFICATIONS

LEFT HAND SIDE

| | |
|----------|----------|
| MATERIAL | Corflute |
| LENGTH | 20.6m |
| HEIGHT | 0.58m |

SPECIFICATIONS

RIGHT HAND SIDE

| | |
|----------|----------|
| MATERIAL | Corflute |
| LENGTH | 20.5m |
| HEIGHT | 0.58m |

INTERNAL

Sinclair Stand – Upper/Tier Rectangle Banner

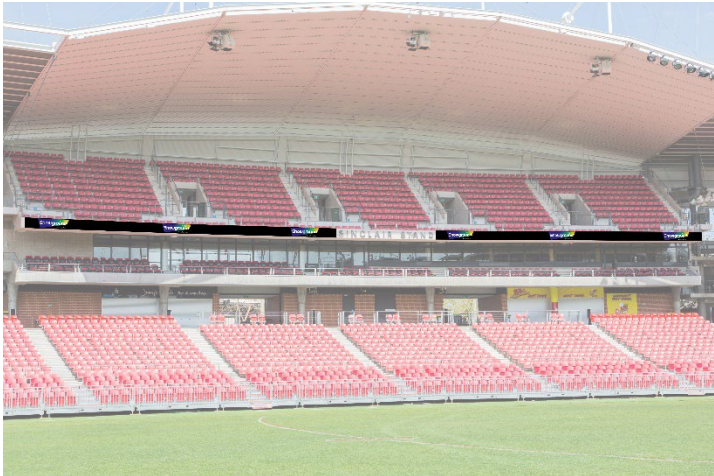

SPECIFICATIONS
LEFT HAND SIDE

| | |
|----------|----------|
| MATERIAL | Corflute |
| LENGTH | 20.65m |
| HEIGHT | 0.58m |

SPECIFICATIONS
RIGHT HAND SIDE

| | |
|----------|----------|
| MATERIAL | Corflute |
| LENGTH | 20.45m |
| HEIGHT | 0.58m |

INTERNAL

Suttor Stand – Upper/Tier Rectangle Banner

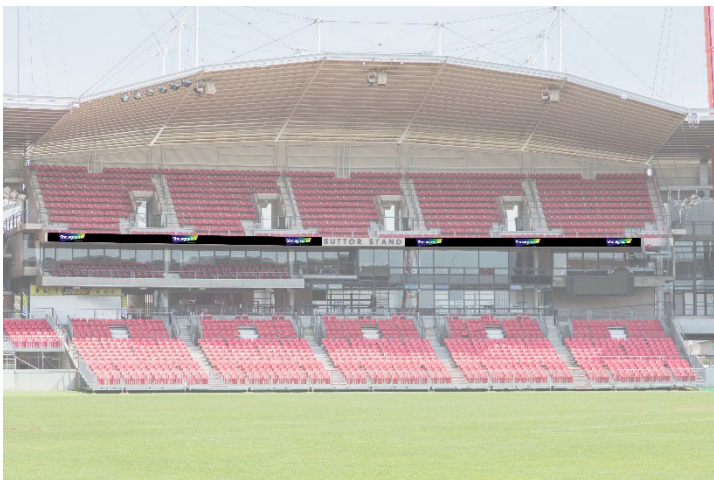

SPECIFICATIONS
LEFT HAND SIDE

| | |
|----------|----------|
| MATERIAL | Corflute |
| LENGTH | 29.3m |
| HEIGHT | 0.58m |

SPECIFICATIONS
RIGHT HAND SIDE

| | |
|----------|----------|
| MATERIAL | Corflute |
| LENGTH | 18.5m |
| HEIGHT | 0.58m |

INTERNAL

Vincent Fairfax Stand – Rectangle Banner

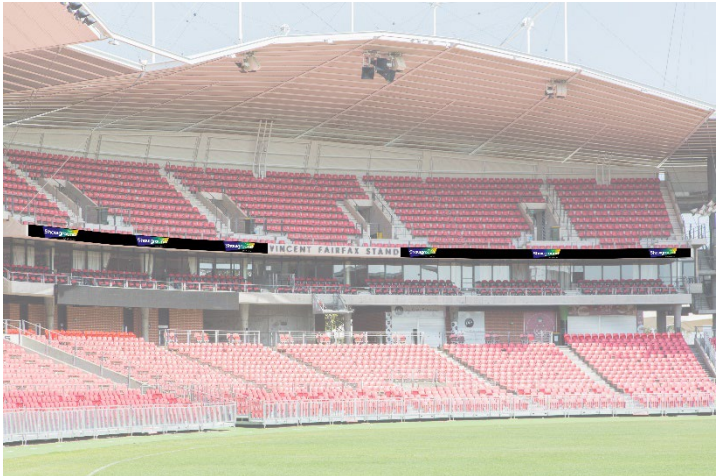

SPECIFICATIONS
LEFT HAND SIDE

| | |
|----------|----------|
| MATERIAL | Corflute |
| LENGTH | 21.5m |
| HEIGHT | 0.58m |

SPECIFICATIONS
RIGHT HAND SIDE

| | |
|----------|----------|
| MATERIAL | Corflute |
| LENGTH | 21.55m |
| HEIGHT | 0.58m |

INTERNAL

Martin & Angus Stand – Rectangle Banner

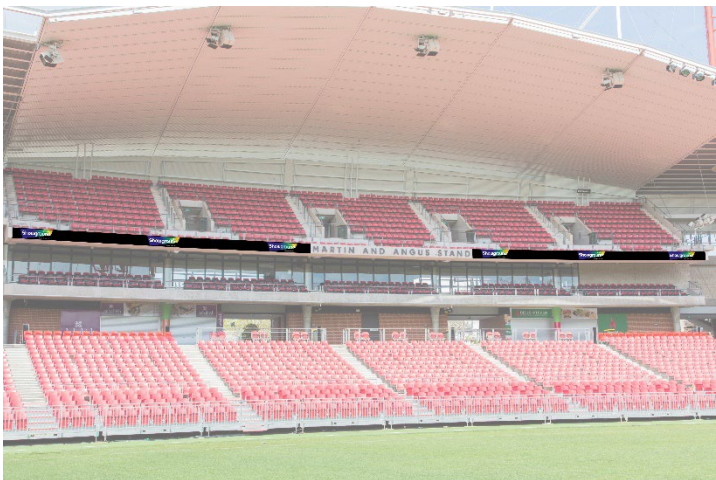

SPECIFICATIONS
LEFT HAND SIDE

| | |
|----------|----------|
| MATERIAL | Corflute |
| LENGTH | 46.5m |
| HEIGHT | 0.58m |

SPECIFICATIONS
RIGHT HAND SIDE

| | |
|----------|----------|
| MATERIAL | Corflute |
| LENGTH | 47.2m |
| HEIGHT | 0.58m |

INTERNAL

Sydney Royal Stand – Rectangle Banner



SPECIFICATIONS

| | |
|----------|----------|
| MATERIAL | Corflute |
| LENGTH | 45m |
| HEIGHT | 0.7m |

VOM 3 TUNNEL SIGNAGE

INTERNAL

Overhead Signage

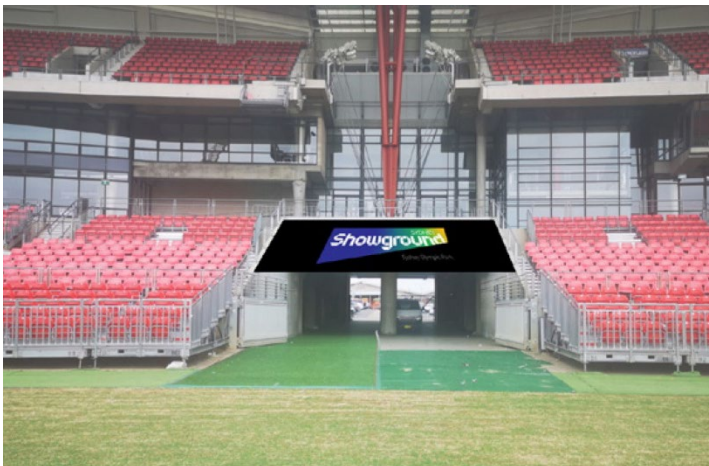

SPECIFICATIONS

KEDDAR BANNER DIMENSIONS

| | |
|----------|-------------------------|
| MATERIAL | PVC Banner, Keddar Edge |
| WIDTH | 9.08m |
| HEIGHT | 4.93m |

VOM 3 TUNNEL SIGNAGE

INTERNAL

Wall Banner



| SPECIFICATIONS | |
|--------------------|-------------------------|
| OVERALL DIMENSIONS | |
| MATERIAL | PVC Banner, Keddar Edge |
| SIDE A | 1.58m |
| SIDE B | 7.13m |
| SIDE C | 4.09m |

INTERNAL

Wall Banner



| SPECIFICATIONS | |
|--------------------|-------------------------|
| OVERALL DIMENSIONS | |
| MATERIAL | PVC Banner, Keddar Edge |
| SIDE A | 6m |
| SIDE B | 2.13m |
| SIDE C | 2.26m |

SYDNEY ROYAL STAND FOYERS

INTERNAL

Banners



SPECIFICATIONS

TRACK WIDTH

| | |
|-------|----|
| WIDTH | 3m |
|-------|----|

SPECIFICATIONS

BANNER DIMENSIONS

| | |
|----------|------------|
| MATERIAL | PVC Banner |
| WIDTH | 1.2m |
| HEIGHT | 2.4m |

SKYDECK

EXTERNAL

Left Return



| SPECIFICATIONS | |
|----------------|---------------------|
| MATERIAL | 3.5mm Di Bond Panel |
| WIDTH | 3.375m |
| HEIGHT | 0.602m |

EXTERNAL

Left Return



| SPECIFICATIONS | |
|----------------|---------------------|
| MATERIAL | 3.5mm Di Bond Panel |
| WIDTH | 10.820m |
| HEIGHT | 0.602m |

SKYDECK
EXTERNAL
Right Return



| SPECIFICATIONS | |
|----------------|---------------------|
| MATERIAL | 3.5mm Di Bond Panel |
| WIDTH | 3.280m |
| HEIGHT | 0.602m |

CHARLEY ROOM

INTERNAL

Second Privacy Screen



SPECIFICATIONS

OVERALL DIMENSIONS

| | |
|--------|-------|
| WIDTH | 2.4m |
| HEIGHT | 2.55m |

SPECIFICATIONS

BANNER DIMENSIONS

| | |
|----------|------------|
| MATERIAL | PVC Banner |
| WIDTH | 1.13m |
| HEIGHT | 2.4m |

INTERNAL

Bathroom Banners



SPECIFICATIONS

OVERALL DIMENSIONS

| | |
|--------|-------|
| WIDTH | 5.75m |
| HEIGHT | 2.34m |

SPECIFICATIONS

BANNER DIMENSIONS

| | |
|----------|------------|
| MATERIAL | PVC Banner |
| WIDTH | 0.93m |
| HEIGHT | 2.28m |

CHARLEY ROOM

INTERNAL

Hanging Panels



SPECIFICATIONS

TRACK WIDTH

| | |
|-------|------|
| WIDTH | 2.4m |
|-------|------|

SPECIFICATIONS

PANEL DIMENSIONS

| | |
|----------|------------|
| MATERIAL | PVC Banner |
| WIDTH | 1.2m |
| HEIGHT | 0.8m |

CHANGE ROOM 1
INTERNAL
Hanging Panels

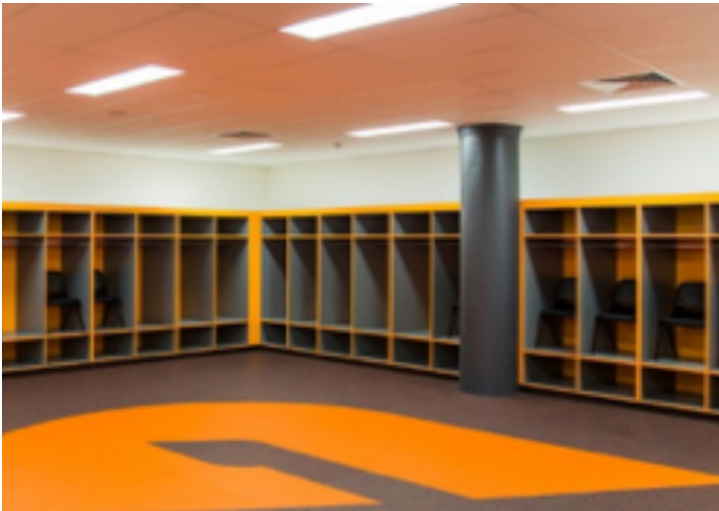

| SPECIFICATIONS | |
|----------------|----|
| TRACK WIDTH | |
| WIDTH | 2m |

| SPECIFICATIONS | |
|-------------------|----------|
| BANNER DIMENSIONS | |
| MATERIAL | Corflute |
| WIDTH | 2.4m |
| HEIGHT | 1.2m |

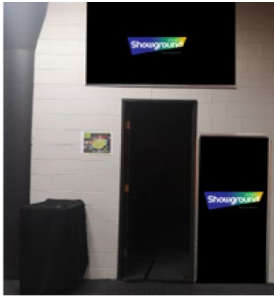
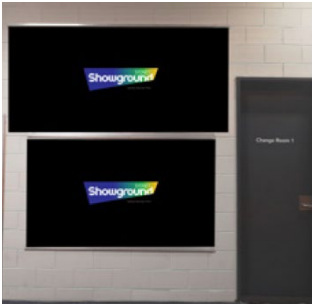

CHANGE ROOM 2

INTERNAL

Wall Banner - A



| SPECIFICATIONS | |
|--------------------|----------|
| OVERALL DIMENSIONS | |
| MATERIAL | Corflute |
| LENGTH | 3.6m |
| HEIGHT | 1.16m |

INTERNAL

Wall Banner - C

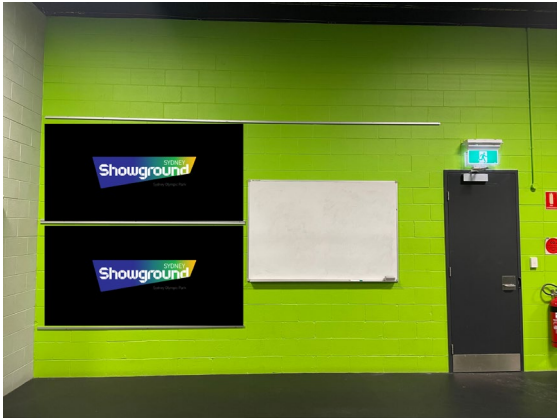

INTERNAL

Wall Banner - B



| SPECIFICATIONS | |
|--------------------|---|
| OVERALL DIMENSIONS | |
| MATERIAL | Corflute |
| LENGTH | Top left 4.63m Top right 4.18m Bottom 9.39m |
| HEIGHT | Top 1.16m Bottom 1.19m |

| SPECIFICATIONS | |
|--------------------|----------|
| OVERALL DIMENSIONS | |
| MATERIAL | Corflute |
| LENGTH | 3.6m |
| HEIGHT | 1.2m |

CHANGE ROOM 2

INTERNAL

Wall Banner - D



| SPECIFICATIONS | |
|--------------------|----------|
| OVERALL DIMENSIONS | |
| MATERIAL | Corflute |
| LENGTH | 3.75m |
| HEIGHT | 1.16m |

INTERNAL

Wall Banner - E



| SPECIFICATIONS | |
|--------------------|-------------------------|
| OVERALL DIMENSIONS | |
| MATERIAL | Corflute |
| LENGTH | Top 9.7m Bottom 6.1m |
| HEIGHT | 1.16m |

CHANGE ROOM 2

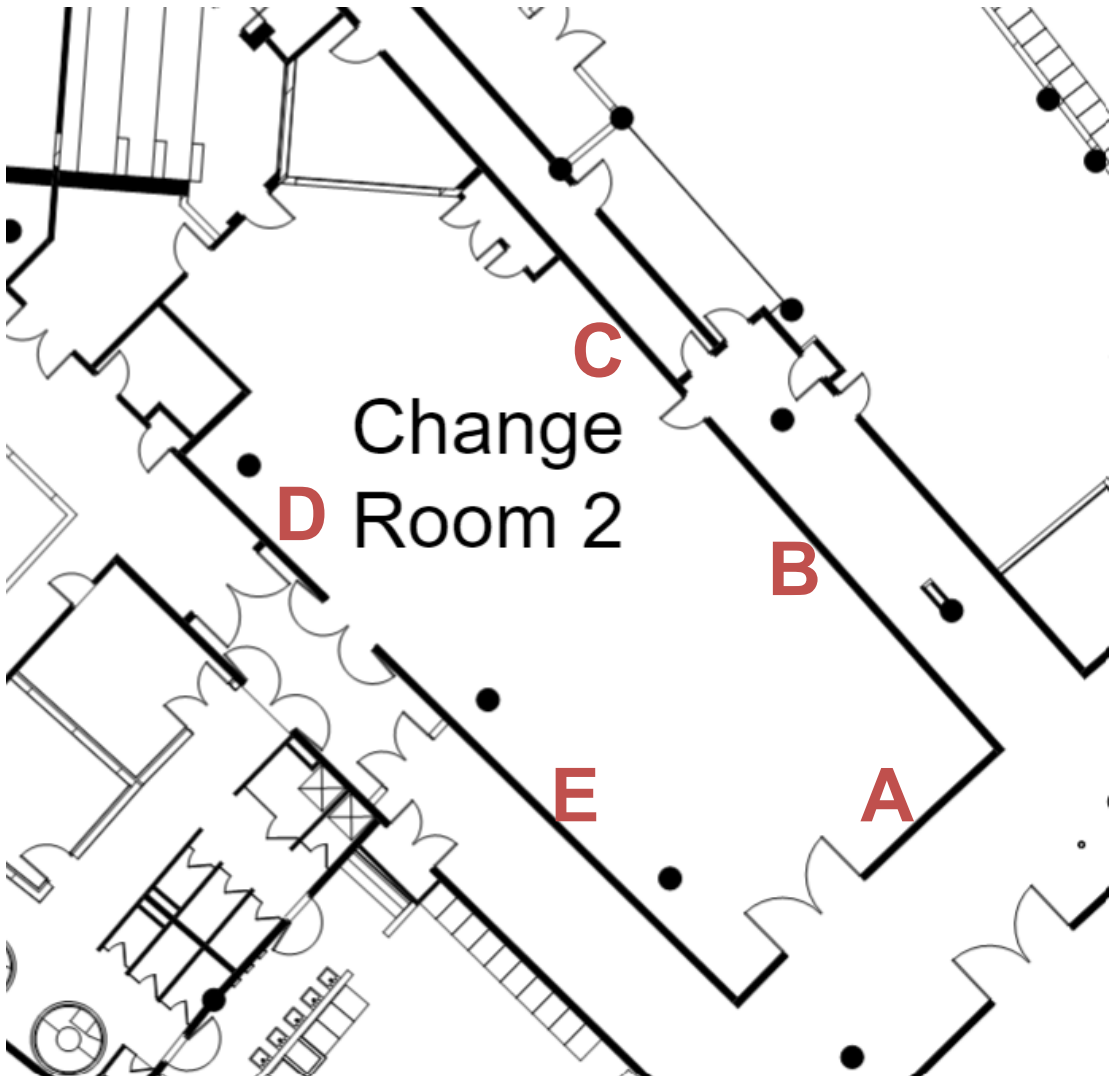

PRECINCT



EXTERNAL

Blade



| SPECIFICATIONS | |
|----------------|-------------------------|
| MATERIAL | 3mm corflute |
| OVERALL | H3500mm x W900mm |
| FRONT | 1220 x 900mm x 2 panels |
| BACK | 1220 x 900mm x 2 panels |
| QTY | 15 |
| PRICE | \$70.00 per sign |

EXTERNAL

Column – Medium Blade



| SPECIFICATIONS | |
|----------------|------------------------|
| MATERIAL | 3mm corflute |
| OVERALL | H2870mm x W600mm |
| PANEL 1 SIZE | 910 x 590mm x 2 panels |
| PANEL 2 SIZE | 910 x 590mm x 2 panels |
| QTY | 10 |
| PRICE | \$50.00 per sign |

EXTERNAL

Showground Rd & Grand Parade Banners



SPECIFICATIONS

| | |
|------------|-------------------------------|
| MATERIAL | Woven Polyester (large/small) |
| SHOWGROUND | H5.3m x W0.94m |
| GRAND | H2.98m x W0.89m |
| PRICE | POA |

Refer to SOPA Signage Guidelines for further information

EXTERNAL

Two-window Ticket Booth



SPECIFICATIONS

| | |
|-----------------------|------------------|
| BETWEEN GLASS WINDOWS | H785mm x W450mm |
| ABOVE GLASS WINDOWS | H410mm x W1450mm |

MAP

Flag pole locations



DIGITAL SIGNAGE



Extend Your Brand at your next Sydney Showground event

Sydney Showground have two prime locations where there is opportunity to display digital event signage or event branding; the exterior of the Dome entrance, and the interior Dome foyer.

Exterior Dome Entrance 3mm Transparent LED



Interior Dome Foyer 2mm LED

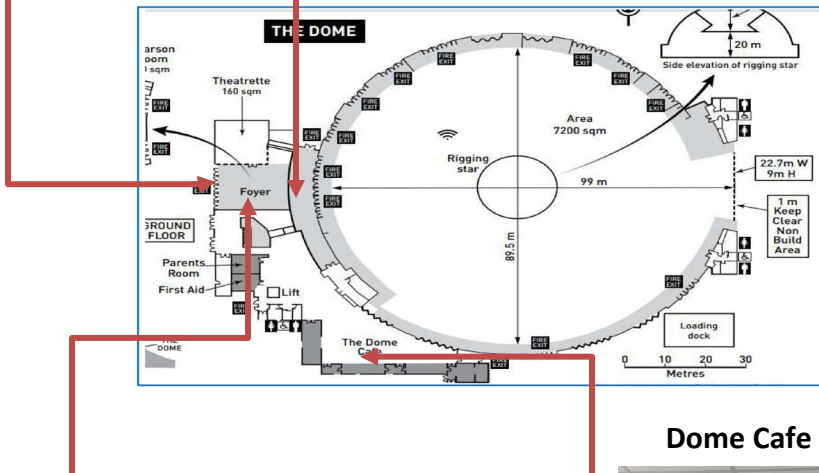

Dome Foyer

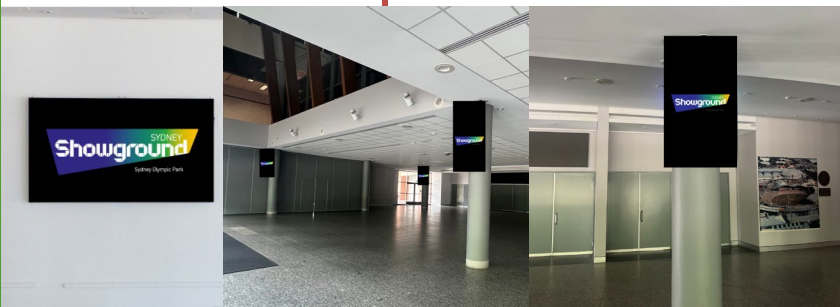

Dome Cafe



Introducing Sydney Showground Digital Screens. What a great way to extend your brand during your expo, or a great addition to your sponsorship suite (you can on-sell the screens to your customers or provide them as a value add).

Screen Locations

- Dome Foyer side wall 100% of time
- Dome entry doors 100% of time
- Dome Foyer pillars 100% of time
- Dome Café screens 50% of time
- (eg 30 seconds in every minute or 3 x 10 second blocks)
- All other screens 10 seconds or 16%+ of time
- 20 screens in total across the Dome and Halls.

Speak to your Account Manager or Event Representative for more details on how our digital signage solution can add value to your event.

Costs:

| | |
|----------------------------|--------|
| Interior Cafe screens | \$500 |
| Dome Foyer pillar screens | \$500 |
| Dome Foyer wall Screen | \$350 |
| Interior Dome Foyer LED | \$500 |
| Exterior Dome Entrance LED | \$1000 |

Dome Foyer Screen Package \$1000
(includes 4 pillar screens, side wall and interior LED screen)

All pricing is based per event.

Specifications – Dome Foyer & Cafes

Images

Portrait – JPEG, 1080x1920, 72dpi, RGB

Landscape – JPEG, 1920x1080, 72dpi, RGB

Animation

Flash - .swf

Movie

Windows Media Video - .wmv

Portrait 1080x1920, 25fps, 8000 bits

Landscape

1920x1080, 25fps, 8000 bits

Screen Zoning

When screen zoning is required – multiple playlists or media files on each screen, the area of 1920x1080 or 1080x1920 can be divided to whatever is required.

The media files associated to those zones should be created in the same aspect ratio as the area zoned.

For example: If you have a landscape screen with two zones, split down the middle, the resolution of each zone would be 960x1080.

The Dome Digital Signage – Technical Specifications

Exterior Dome LED Entrance 3mm Pitch, Transparent LED

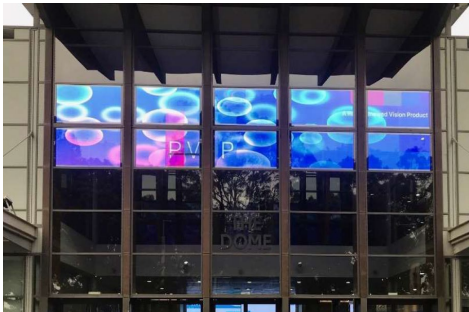

10 x Individual Panels

Individual panel pixel size - 504 W x 256 H
Overall pixel size - 2520 W x 512 H Black/
dark gradient colours create the transparent effect
eg. 100% black = 100% transparent

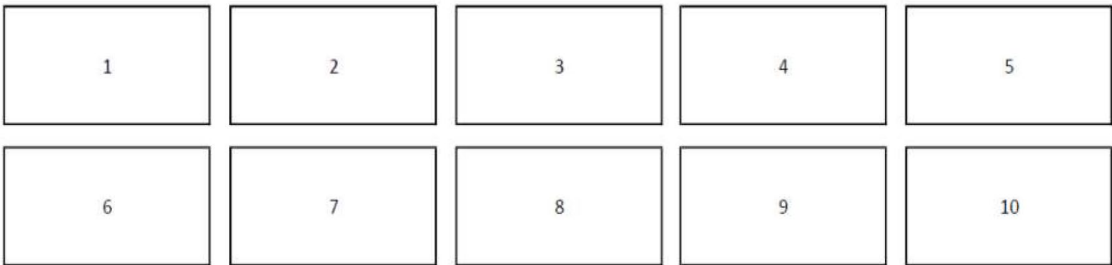

| FILE | |
|--------|-------------|
| VIDEO | .MP4 (H264) |
| | .AVI |
| STATIC | .JPEG |
| | .GIF |
| | .BMP |
| | .PNG |

- Other file types may be possible, or may have to be converted to one of the above files types. Additional charges may be incurred.
- A sample file must be submitted 14 days before tenancy for testing purposes, and the final files 7 days before event commences.
- Should you not wish to utilise the Dome screens, Sydney Showground will display safety and venue messaging.

The Dome Digital Signage – Technical Specifications

Interior Dome LED Entrance
Overall pixel size - 3456 W x 384 H



| FILE | |
|--------|-------------|
| VIDEO | .MP4 (H264) |
| | .AVI |
| STATIC | .JPEG |
| | .GIF |
| | .BMP |
| | .PNG |

- Other file types may be possible, or may have to be converted to one of the above files types. Additional charges may be incurred.
- A sample file must be submitted 14 days before tenancy for testing purposes, and the final files 7 days before event commences.
- Should you not wish to utilise the Dome screens, Sydney Showground will display safety and venue messaging.

Dome – Somerville & Pearson Screens

Pearson Room
65inch TV



Somerville Room
65inch TV

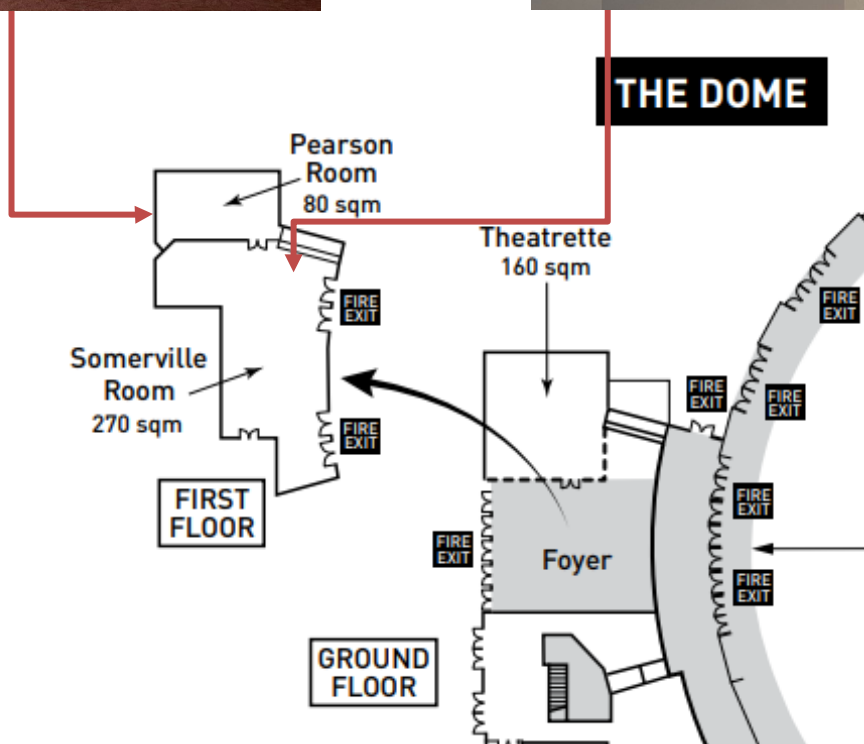

Dome – Somerville & Pearson Screens

Screen Locations

- Somerville & Pearson screens 100% of time, useful for presentations

Speak to your Account Manager or Event Representative for more details on how our digital signage solution can add value to your event.

Costs:

| | |
|------------|-------|
| Somerville | \$200 |
| Pearson | \$200 |

All pricing is based per event.

Specifications – Dome Foyer & Cafes

Images

Landscape – JPEG, 1920x1080, 72dpi, RGB

Animation

Flash - .swf

Movie

Windows Media Video - .wmv

Portrait 1080x1920, 25fps, 8000 bits

Landscape

1920x1080, 25fps, 8000 bits

ClickShare Technology

As part of the new digital signage system we have included 'Clickshare' on a number of monitors that enables wireless presentation to be undertaken direct from a laptop.

Each relevant monitor has a dongle plugged into a base station connected to the monitor which can be removed from the base station and inserted directly into a laptop that has a USB C port. Simply wait for it to 'pair' and off you go.

Any dongles damaged or lost will incur a replacement fee.

Halls 2 – 4 Screens

North Pod 65inch TV



South Pod 65inch TV

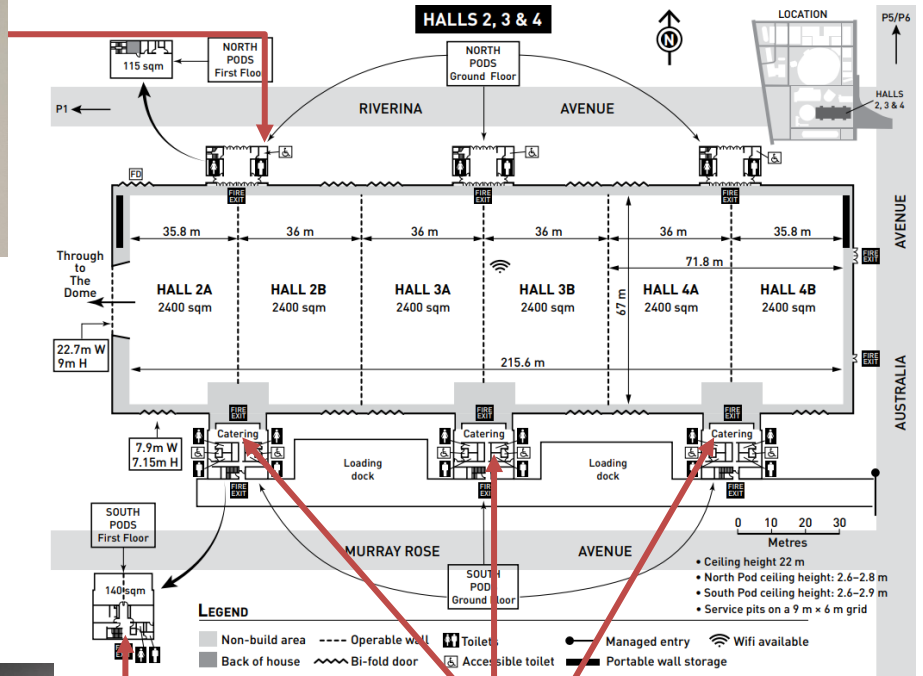
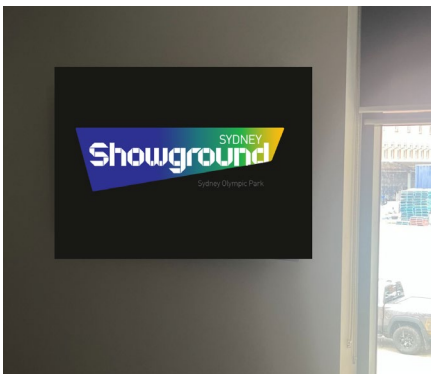

Hall Cafés 50inch TVs



Halls 2 – 4 Screens

Screen Locations

- Hall Café screens 50% of time
- (eg 30 seconds in every minute or 3 x 10 second blocks)
- North & South Pods 100% of time, useful for presentations

Speak to your Account Manager or Event Representative for more details on how our digital signage solution can add value to your event.

Costs:

| | |
|--------------------------------|-------|
| Pod screens | \$200 |
| Hall Café Screens (3 per cafe) | \$500 |

All pricing is based per event.

Specifications – Dome Foyer & Cafes

Images

Landscape – JPEG, 1920x1080, 72dpi, RGB

Animation

Flash - .swf

Movie

Windows Media Video - .wmv

Portrait 1080x1920, 25fps, 8000 bits

Landscape

1920x1080, 25fps, 8000 bits

ClickShare Technology

As part of the new digital signage system we have included 'Clickshare' on a number of monitors that enables wireless presentation to be undertaken direct from a laptop.

Each relevant monitor has a dongle plugged into a base station connected to the monitor which can be removed from the base station and inserted directly into a laptop that has a USB C port. Simply wait for it to 'pair' and off you go.

Any dongles damaged or lost will incur a replacement fee.

Halls 5 & 6 Screens

Hall 5 Foyer
55inch TV



Function Room 5
75inch TV

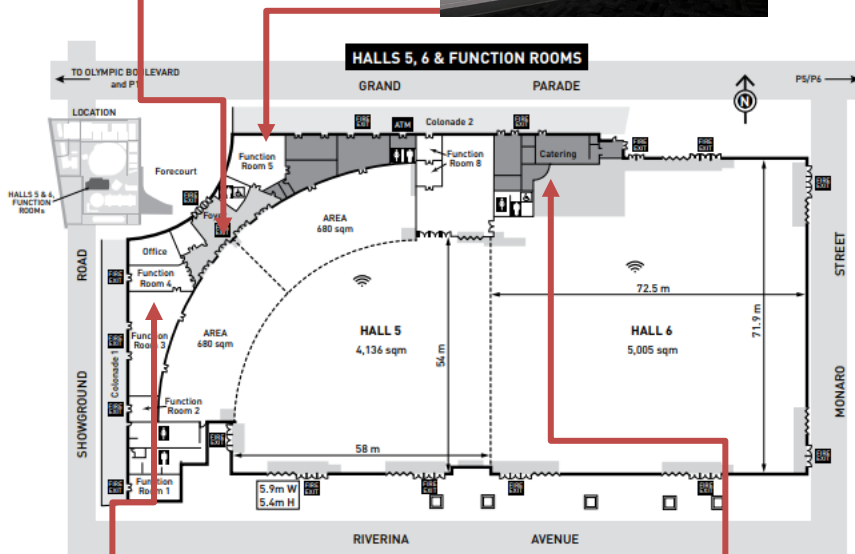
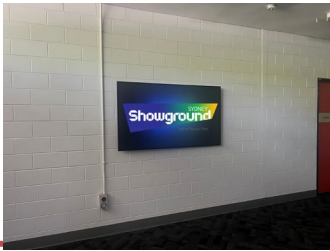

Function Room 3
75inch TV



Hall 6 Café
75inch TV

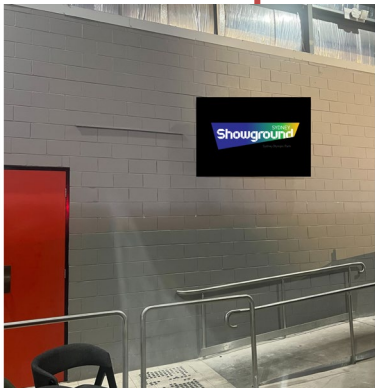

Halls 5 & 6 Screens

Screen Locations

- Hall 5 Foyer 100% of time
- Hall 6 Café screens 50% of time
- (eg 30 seconds in every minute or 3 x 10 second blocks)
- Function Rooms 3 & 5 100% of time, useful for presentations

Speak to your Account Manager or Event Representative for more details on how our digital signage solution can add value to your event.

Costs:

| | |
|-----------------------|-------|
| Hall 5 Foyer screen | \$200 |
| Function Room screens | \$200 |
| Hall 6 Café Screen | \$250 |

All pricing is based per event.

Specifications – Dome Foyer & Cafes

Images

Landscape – JPEG, 1920x1080, 72dpi, RGB

Animation

Flash - .swf

Movie

Windows Media Video - .wmv

Portrait 1080x1920, 25fps, 8000 bits

Landscape

1920x1080, 25fps, 8000 bits

ClickShare Technology

As part of the new digital signage system we have included ‘Clickshare’ on a number of monitors that enables wireless presentation to be undertaken direct from a laptop.

Each relevant monitor has a dongle plugged into a base station connected to the monitor which can be removed from the base station and inserted directly into a laptop that has a USB C port. Simply wait for it to ‘pair’ and off you go.

Any dongles damaged or lost will incur a replacement fee.

Stadium Level 2 Parapet

Video

LED
1600W x 72H



LED
1040W x 72H



LED
720W x 72H



| VIDEO | |
|--------------------|--|
| PIXEL DIMENSIONS | 1040 x 72px 720 x 72px |
| ANIMATION DURATION | 30 seconds |
| FRAMES PER SECOND | 30 (FPS) Use the whole stage as there is no safe zone |

We recommend using video versus static images. The movement/animation in video provides a higher impact and engagement with fans.

SIGNAGE REQUIREMENTS



Sydney Showground Minimum Requirements for Signage

1. Minimum Manufacturing Requirements

The minimum manufacturing requirements are:

- I. Load:
 - a. Top pocket or eyelets – 14kg per lineal metre of the width plus the weight of banner.
 - b. Bottom pocket – 14kg per lineal metre of the width of the banner.
- II. Pockets to be hot air welded and stitched.
- III. Eyelets to be reinforced (webbing affixed).

Please ensure that all manufacturers undertaking Sydney Showground work through you are made aware of these minimum manufacturing requirements and provide a Quality Assurance Statement from the supplier/manufacture stating that any newly produced signage meets or exceeds the standards outlined within the minimum manufacturing requirements and therefore is fit for purpose.

2. Minimum Rigging and De-Rigging Requirements

Any banner requiring hanging at a height above 2.4m must be rigged by the Sydney Showground authorised rigger.

Sydney Showground has a large rigging capacity within the Exhibition Halls & Secondary Pavilions; detailed plans are available on request. Rigging plans must be submitted to the Sydney Showground to review two weeks prior to the licence period commencing.

Rigging within Sydney Showground's secondary pavilions must be signed off by a certified structural engineer.

3. Minimum Installation Requirements

At all times the presentation standards of the Sydney Showground along with best practise installation methods are to be upheld.

The Sydney Showground does not permit the sticking, posting, hanging or attaching of any signage, notices, banners or advertisements on ceilings, floors, walls, walkways, railings, fences or any property belonging to the Sydney Showground without prior written approval. Any fixing items used must not damage Sydney Showground property. The cost of repair due to damage sustained from the use of nonapproved fixing agents will be borne by the Signage Installation company. Any damage caused will be charged back to the licensee.

Should a sign be affixed to a temporary structure or frame, the structure or frame must abide by the New South Wales, State Legislative Requirements as set out in the "State Environmental Planning Policy (Temporary Structures and Places of Public Entertainment) Amendment (Temporary Structures)– 2009" and be signed off by a certified structural engineer supplied by the Contractor responsible for the installation of the sign. Upon approval, an engineer's certificate must be provided to the Sydney Showground Signage Coordinator.

Site Wide Signage

Sydney Showground will seek permission on the licensee's behalf for any signage placed outside the Sydney Showground site from the local authority. This includes signage or banners placed on any fenceline that faces a roadway.

Promotional Signage

Promotional signage may be displayed only within the licensee's immediate licensed area. Permission and approval of all promotional signage is required prior to being displayed. Signage on site takes into consideration ALL events that are operational at any one time. The decision on how signage space is allocated is at the discretion of Sydney Showground.

Naming

Naming Protocol

The correct naming of the venue is:

Sydney Showground at Sydney Olympic Park

Sydney Showground is the venue and Sydney Olympic Park is the suburb. Under no circumstances are the words 'Homebush' or 'Homebush Bay' to be used on any print or digital signage or other marketing collateral including TV commercials and radio announcements.

Correct naming will ensure that your customers know exactly where to find the venue and your event. Use of incorrect suburb names can lead to confusion including customers getting off at the wrong train station or driving to the wrong suburb.

Please ensure final proof of signage is sent to your Event Planner prior to printing.



1 Showground Road, Sydney Olympic Park, NSW 2127 Australia
 Phone +61 2 9704 1157 Email sales@sydneyshowground.com.au
www.sydneyshowground.com.au