

OPERATIONAL REGULATIONS

**SIGNAGE  
COMPENDIUM**



# Contents

<b><u>DOME</u></b>	<b>3</b>
External	
<b><u>EXHIBITION HALLS</u></b>	<b>8</b>
External	
Internal	
North Pod	
South Pod	
Halls 5 & 6	
<b><u>CHARLES MOSES STADIUM</u></b>	<b>19</b>
External	
Internal	
<b><u>PAVILIONS</u></b>	<b>23</b>
Sydney Royal Stables	
Downes	
Falkiner	
Grace	
Mackay	
Munro	
Murchison	
Paddington	
Howie	
<b><u>STADIUM</u></b>	<b>29</b>
External	
Scoreboard	30
Entry & Stands	31
Stadium Ticket box	33
Internal	
Interchange Bench	35
Stands	36
Vom 3 Tunnel	39
Sydney Royal Stand Foyers	41
Skydeck	42
Charley Room	44
Change Room 1	46
Change Room 2	47
Lifts	50
<b><u>PRECINCT</u></b>	<b>51</b>
External	
<b><u>DIGITAL SIGNAGE</u></b>	<b>55</b>
<b><u>SIGNAGE REQUIREMENTS</u></b>	<b>67</b>



# DOME



EXTERNAL

Dome Entrance Foyer



LARGE BANNER			
MATERIAL	WIDTH	HEIGHT	QTY
PVC	12400mm	5150mm	1

SMALL BANNER			
MATERIAL	WIDTH	HEIGHT	QTY
PVC	7500mm	4500mm	1

**INSTALLATION:** Catenary Wire installation. Refer to rigging company for engineering.

EXTERNAL

Wall Banner



WALL BANNER	
MATERIAL	PVC
WIDTH	5070mm
HEIGHT	3550mm
QTY	6

**INSTALLATION:** Top: Eyelets  
Bottom: Rope edge







EXTERNAL

Dome Entrance Foyer



WINDOW DECALS	
MATERIAL	Decal
WIDTH	1 - 6 – 2130mm
HEIGHT	1, 4 – 1080mm 2, 3 – 1130mm 5 – 1110mm 6 – 1490mm

Mullions	
MATERIAL	NA
WIDTH	A – 200mm  B – 360mm 
HEIGHT	C – 50mm  D – 120mm 

EXTERNAL  
**Dome Entrance Foyer**



WINDOW DECALS	
MATERIAL	Decal
WIDTH	1, 2, 3 – 1050mm 4, 5, 6 – 650mm
HEIGHT	1, 6 – 1110mm 2, 5 – 1140mm 3, 4 – 650mm

EXTERNAL

Dome Ticket Box



WINDOW DECALS	
MATERIAL	Decal
WIDTH	1 – 1825mm 2 – 1760mm 3 – 420mm 4 – 540mm 5 – 485mm
HEIGHT	1, 2 – 1140mm 3 – 425mm 4, 5 – 1020mm



# EXHIBITION HALLS



## EXTERNAL

### Dome Entrance Foyer



#### SPECIFICATIONS

MATERIAL	PVC
WIDTH	9630mm
HEIGHT	3600mm
QTY	2 (per hall)

**INSTALLATION:** All sides: Eyelets

## EXTERNAL

### External Foyer Wall



#### SPECIFICATIONS

MATERIAL	PVC
WIDTH	2300mm
HEIGHT	2300mm
QTY	2 (per hall)

EXTERNAL

**Side Triangle**

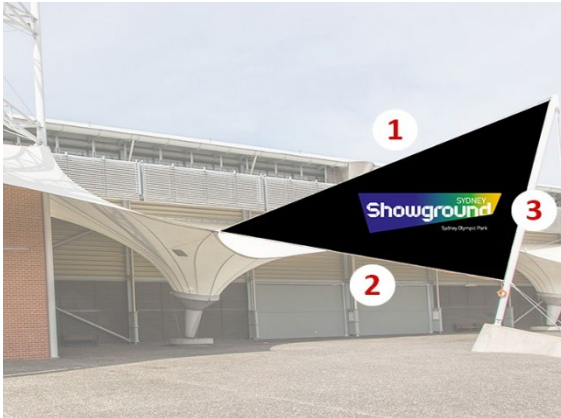

SPECIFICATIONS				
MATERIAL	SIDE 1	SIDE 2	SIDE 3	QTY
PVC	12150mm	10030mm	6750mm	2 (per hall)

SQUARED OFF CORNERS		
SIDE 1-2	SIDE 1-3	QTY
120mm (W)	250mm (W)	2

**INSTALLATION:** All sides: PVC Banner, Eyelets All Sides

EXTERNAL

**Side Triangle**



SPECIFICATIONS	
MATERIAL	PVC
SIDE 1	8100mm
SIDE 2	8100mm
SIDE 3	4000mm
QTY	2 (per hall)

**INSTALLATION:** All sides: Eyelets



INTERNAL

**Internal Pod Signage (Hall 2 - 4)**



**NORTH PODS LEVEL 2**

**INTERNAL WINDOWS LHS & RHS**

TOP HALF	W 1650 x H 950mm
BOTTOM HALF	W 1650 x H 1130mm
MATERIAL	Banner/Corflute/Decal

INTERNAL

**North Pod – Level 2 Front Window**



**NORTH POD LEVEL 2**

**FRONT WINDOW**

TOP HALF	W 2200 x H 1100mm
BOTTOM HALF	W 2200 x H 1100mm
MATERIAL	Banner/Corflute/Decal

INTERNAL

North Pod Foyer



DOORS X 2	
WIDTH	4800mm
HEIGHT	560mm

SIDE OF WALL FOYER	
WIDTH	2400mm
HEIGHT	1200mm

INTERNAL

South Pods – Level 2



SOUTH PODS LEVEL 2	
INTERNAL WINDOWS LHS & RHS	
TOP HALF	W 1650 x H 950mm
BOTTOM HALF	W 1650 x H 1130mm
MATERIAL	Banner/Corflute/Decal

INTERNAL  
**South Pod – Level 2 Front Window**



SOUTH POD LEVEL 2 FRONT WINDOW	
TOP HALF	W 2200 x H 1100mm
BOTTOM HALF	W 2200 x H 1100mm
MATERIAL	Banner/Corflute/Decal

EXTERNAL  
**Hall 5A Function Room 3 Entry**



HALL 5A FUNCTION ROOM 3 ENTRY SHOWGROUND RD	
DIMENSIONS	5820 X 4000 x 2100mm
MATERIAL	PVC Corner Eyelets

**LOCATION:** Showground Rd – Outside  
Southee 3



EXTERNAL

**Hall 5A Main Entry Foyer – Right Hand Side**



**HALL 5A MAIN ENTRY FOYER  
RIGHT HAND SIDE**

DIMENSIONS	W 20070 x H 1300mm
MATERIAL	PVC Track Mounted

**INSTALLATION:** Sail track on top deck and eyelets on the bottom.

**LOCATION:** Corner of Grand Pde & Showground Rd existing Southee Complex Entry point

EXTERNAL

**Hall 5A Main Entry Foyer – Left Hand Side**



**HALL 5A MAIN ENTRY FOYER  
LEFT HAND SIDE**

DIMENSIONS	W 15500 x H 1300mm
MATERIAL	PVC Track Mounted

**INSTALLATION:** Sail track on top deck and eyelets on the bottom.

**LOCATION:** Corner of Grand Pde & Showground Rd existing Southee Complex Entry point

EXTERNAL

**Hall 5A Main Entry Foyer - Doors**



**HALL 5A MAIN ENTRY FOYER  
DOORS**

DIMENSIONS	A - W 240 x H 3100mm
	B - W 2070 x H 450mm
	C - W 910 x H 2470mm
MATERIAL	Decal

EXTERNAL

**Halls 5 & 6 – Window Banners**



**HALLS 5 & 6 – RIVERINA AVE  
ENTRY DOORS**

DIMENSIONS	W 7340 x 2735mm
MATERIAL	Fabric Stretch, with silicon edge Existing frame is in place

**LOCATION:** Riverina Side of Halls 5 & 6  
(Above Entry Doors)

## EXTERNAL Halls 5 & 6 – Riverina Ave



HALLS 5 & 6 – RIVERINA AVE ENTRY DOORS	
MATERIAL	Corflute

**LOCATION:** Riverina Side of Halls 5 & 6  
(Above Entry Doors)

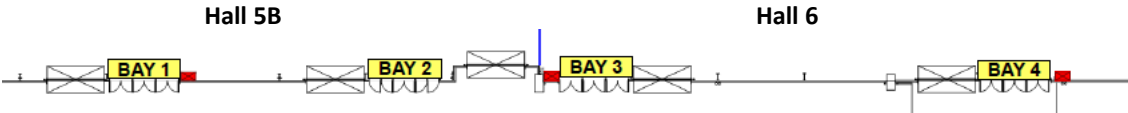

HALLS 5 & 6 – RIVERINA AVE ENTRY DOORS						
	1	2	3	4	5	6
Bay 1	W 1200mm x H 2640 mm	W 1190mm x H 2640mm	W 1200mm x H 2640 mm	W 1200mm x H 2640 mm	W 1190mm x H 2640mm	W 1180mm x H 2640 mm
Bay 2	W 1180mm x H 2640 mm	W 1190mm x H 2640mm	W 1200mm x H 2640 mm	W 1200mm x H 2640 mm	W 1190mm x H 2640mm	W 1180mm x H 2640 mm
Bay 3	W 1185mm x H 2640mm	W 1180mm x H 2640 mm	W 1200mm x H 2640 mm	W 1200mm x H 2640 mm	W 1185mm x H 2640mm	W 1195mm x H 2640mm
Bay 4	W 1205mm x H 2640mm	W 1185mm x H 2640mm	W 1200mm x H 2640 mm	W 1200mm x H 2640 mm	W 1190mm x H 2640mm	W 1175mm x H 2640mm

All of the width measurements have had 10mm deducted so the signage will be easily installable. The tracking runs vertical and measures 65mm in width, the tracking is a H mold design. The signage sheets will sit in 22mm inside the H mold channel each side with 5mm clearance each side.



## SIGNAGE COMPENDIUM

### EXHIBITION HALLS

#### EXTERNAL

#### Halls 5 & 6 – Riverina Ave



#### HALLS 5 & 6 – RIVERINA AVE BANNER LOCATION

DIMENSIONS	W 4800 x H 9000mm Top Width 4000mm
MATERIAL	PVC / Mesh Banner with eyelets

**LOCATION:** Riverina Side of Halls 5 & 6 (2 Banner Points)

#### INTERNAL

#### Halls 5A Foyer



#### HALLS 5A Foyer SIDE WALLS OF FOYER

DIMENSIONS	H 2500 X H 6000 (to 3phase outlet)
MATERIAL	PVC Banner

**LOCATION:** Entry way of Hall 5A Foyer

INTERNAL

Hall 5A Foyer



HALL 5A FOYER ABOVE ENTRY DOORS TO HALL 5A	
DIMENSIONS	H 720 X W 4100
MATERIAL	3mm Corflute

**LOCATION:** Above entry doors in Hall 5A foyer entering Hall 5A

INTERNAL

Halls 5 & 6 – Rigging Opportunities



HALLS 5 & 6 – RIVERINA AVE 2 BANNER POINTS
Custom Rigging Internal
Example only

**LOCATION:** Custom Rigging Internal – Example only

# CHARLES MOSES STADIUM





## SIGNAGE COMPENDIUM

### CHARLES MOSES STADIUM

#### EXTERNAL

#### Charles Moses Entry Square



#### SPECIFICATIONS

MATERIAL	PVC
WIDTH	2200mm
HEIGHT	2200mm
QTY	1

**INSTALLATION:** All sides: Eyelets

#### EXTERNAL

#### Charles Moses Entry Banner

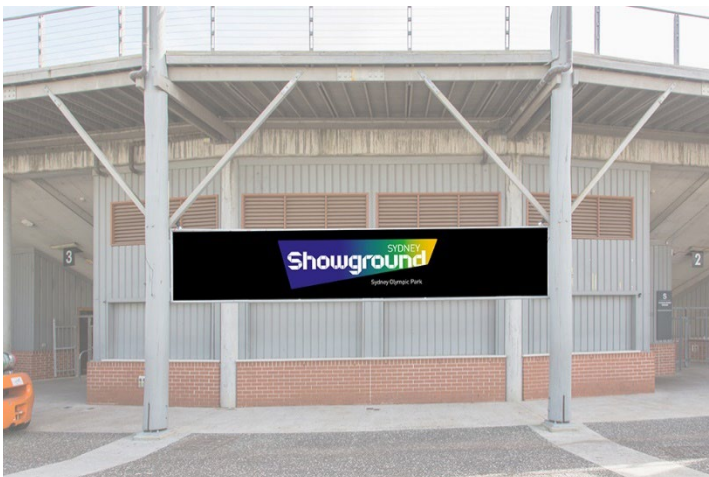

#### SPECIFICATIONS

MATERIAL	PVC
WIDTH	6600mm
HEIGHT	2000mm
QTY	1

## SIGNAGE COMPENDIUM CHARLES MOSES STADIUM

### INTERNAL Balustrade - Side



#### SPECIFICATIONS

MATERIAL	PVC
WIDTH	7300mm
HEIGHT	850mm
QTY	2

**INSTALLATION:** All sides: Eyelets

### INTERNAL Balustrade - Front



#### SPECIFICATIONS

MATERIAL	PVC
WIDTH	8000mm
HEIGHT	1000mm
QTY	1

## SIGNAGE COMPENDIUM CHARLES MOSES STADIUM

**INSTALLATION:** All sides: Eyelets

### INTERNAL

#### Gantry Signage

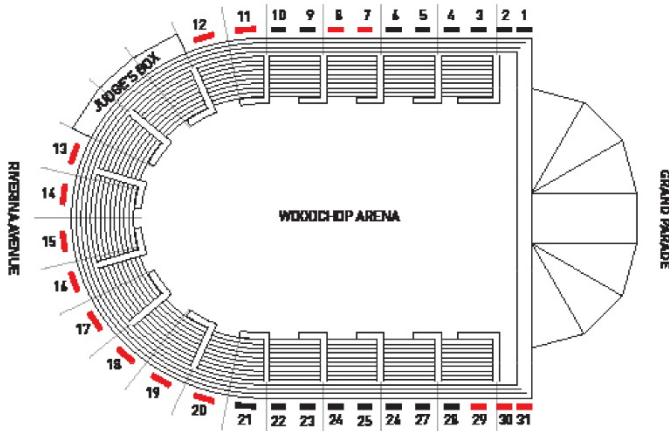

#### Gantry Signage Internal LHS



#### Gantry Signage Internal LHS

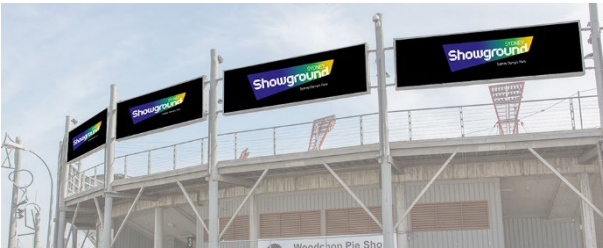

### SITES

SITE 1	2.53m x 1.8m
SITE 2	2.44m x 1.8m
SITE 3	3.87m x 1.8m
SITE 4	3.87m x 1.8m
SITE 5	3.83m x 1.8m
SITE 6	3.8m x 1.8m
SITE 7	3.85m x 1.8m
SITE 8	3.95m x 1.8m
SITE 9	3.86m x 1.8m
SITE 10	3.86m x 1.8m
SITE 11	4.95m x 1.8m
SITE 12	5.6m x 1.8m
SITE 13	5.77m x 1.8m
SITE 14	5.9m x 1.8m
SITE 15	6.01m x 1.8m
SITE 16	6.01m x 1.8m
SITE 17	5.95m x 1.8m
SITE 18	6.0m x 1.8m
SITE 19	5.98m x 1.8m
SITE 20	5.94m x 1.8m
SITE 21	4.96m x 1.8m
SITE 22	3.91m x 1.8m
SITE 23	3.81m x 1.8m
SITE 24	3.92m x 1.8m
SITE 25	3.81m x 1.8m
SITE 26	3.9m x 1.8m
SITE 27	3.86m x 1.8m
SITE 28	3.81m x 1.8m
SITE 29	3.87m x 1.8m
SITE 30	2.51m x 1.8m
SITE 31	2.48m x 1.8m



# PAVILIONS



EXTERNAL

Downes Pavilion



SPECIFICATIONS	
MATERIAL	PVC
WIDTH	6600mm
HEIGHT	2000mm
QTY	3

EXTERNAL

Falkiner Pavilion



SPECIFICATIONS	
MATERIAL	PVC
WIDTH	6600mm
HEIGHT	2000mm
QTY	2

**INSTALLATION:** All sides: Eyelets

## EXTERNAL

### Sydney Royal Stables



#### SPECIFICATIONS

MATERIAL	Poly Flag
LENGTH	1800mm
HEIGHT	1200mm
QTY	3

## INTERNAL

### Lift



#### SPECIFICATIONS

MATERIAL	Decal
WIDTH	910mm
HEIGHT	2100mm



## EXTERNAL Grace Pavilion



### SPECIFICATIONS

MATERIAL	PVC
WIDTH	6600mm
HEIGHT	2000mm
QTY	1

**INSTALLATION:** All sides: Eyelets

## EXTERNAL Mackay Pavilion



### SPECIFICATIONS

MATERIAL	PVC
WIDTH	6600mm
HEIGHT	2000mm
QTY	1

**INSTALLATION:** All sides: Eyelets



## EXTERNAL Munro Pavilion



### SPECIFICATIONS

MATERIAL	PVC
WIDTH	6600mm
HEIGHT	2000mm
QTY	3

## EXTERNAL Murchison Pavilion



### SPECIFICATIONS

MATERIAL	PVC
WIDTH	6600mm
HEIGHT	2000mm
QTY	4

**INSTALLATION:** All sides: Rope edge

## EXTERNAL Paddington Pavilion



### SPECIFICATIONS

MATERIAL	PVC
WIDTH	6600mm
HEIGHT	2000mm
QTY	1

**INSTALLATION:** All sides: Eyelets

## EXTERNAL Howie Pavilion

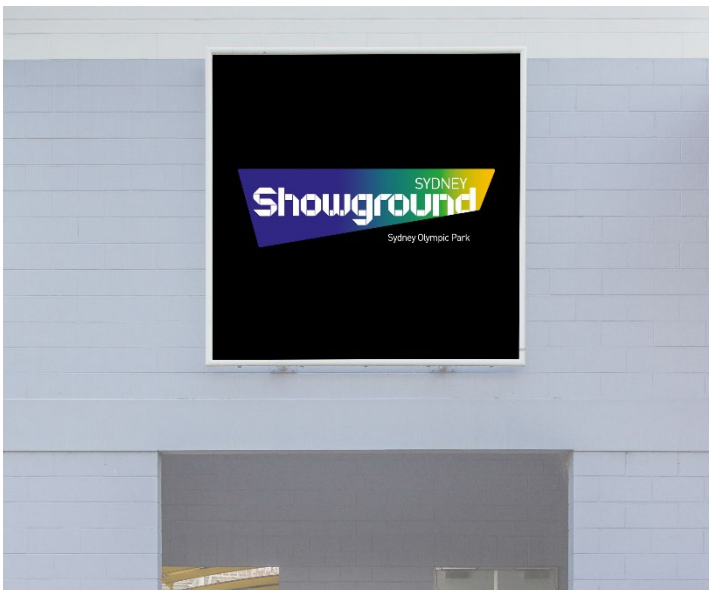

### SPECIFICATIONS

MATERIAL	PVC
WIDTH	2200mm
HEIGHT	2000mm
QTY	2

**INSTALLATION:** All sides: Eyelets



# STADIUM





EXTERNAL

Presidents Plaza – Entrance Canopy



SPECIFICATIONS

MATERIAL	Breeze cloth banner or PVC Banner, keddar edge
WIDEST	8.75m
NARROWEST	3m
PERPENDICULAR	5m

INSTALLATION: Tracking & eyelets

EXTERNAL

Council/Vincent & Fairfax Stands



SPECIFICATIONS

MATERIAL	Breeze cloth banner
WIDTH	10m
HEIGHT	3.1m

INSTALLATION: Webbing & eyelets



EXTERNAL

Upper Rafter Banner – Sinclair Stand



SPECIFICATIONS	
MATERIAL	Breeze cloth banner
WIDTH	10m
HEIGHT	3.1m

**INSTALLATION:** Webbing & eyelets

EXTERNAL

Martin & Angus Stand – Upper Rafter Banner



SPECIFICATIONS	
MATERIAL	Breeze cloth banner
WIDTH	10m
HEIGHT	3.2m

**INSTALLATION:** Webbing & eyelets

## EXTERNAL

### Martin & Angus Stand – Upper Rectangle. Gate B



#### SPECIFICATIONS

MATERIAL	PVC banner
WIDTH	6m
HEIGHT	3m

**INSTALLATION:** Rope edge

## EXTERNAL

### Members Stand – Upper Rafter Banner



#### SPECIFICATIONS

MATERIAL	Breeze cloth banner
WIDTH	10m
HEIGHT	3.1m

**INSTALLATION:** Webbing & eyelets

## SIGNAGE COMPENDIUM STADIUM

### SCORE BOARD

#### EXTERNAL

#### Top Panel



#### SPECIFICATIONS

##### OVERALL

MATERIAL	Fabric Banner with reinforced webbing
----------	---------------------------------------

#### SPECIFICATIONS

##### TOP\*

WIDTH	25.76m
HEIGHT	3.59m

\*Naming rights exclusive

### Side Panels

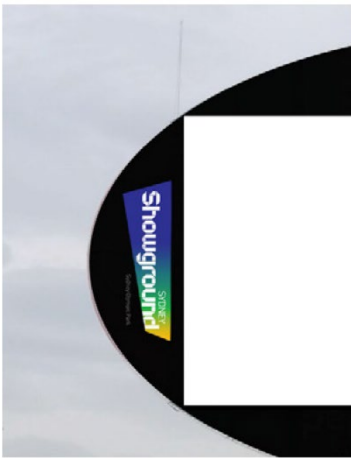

#### SPECIFICATIONS

##### LEFT & RIGHT SIDE\*

WIDTH	3.63m
HEIGHT	11.41m

\*Subject to venue approval

### Bottom Panels



#### LEFT & RIGHT BOTTOM\*

WIDTH	11.05m
HEIGHT	3.24m

\*Subject to venue approval

**INSTALLATION:** Kedder inside edge with eyelets every 500mm along curve. Stainless steel cable ties to secure SS strap eyes on outer return

STADIUM TICKET BOX

EXTERNAL

Window panels – top row only



SPECIFICATIONS	
PANEL DIMENSIONS	
MATERIAL	Decal
WIDTH	700mm
HEIGHT	510mm



## INTERNAL Stadium Internal Fence

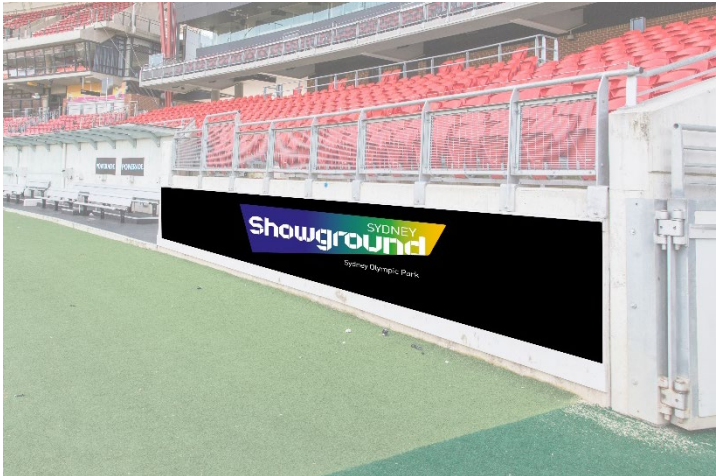

### SPECIFICATIONS

MATERIAL	Corflute
LENGTH	12m
HEIGHT	1.05m

**NOTE:** Signage can be in place with or without temporary seating.

## INTERNAL Interchange bench



### SPECIFICATIONS

#### Bay 1

MATERIAL	Corflute
LENGTH	A - 3.7m B - 3m
HEIGHT	1.2m

### SPECIFICATIONS

#### Bay 2

MATERIAL	Corflute
LENGTH	3.9m
HEIGHT	1.2m



## INTERNAL Interchange Bench

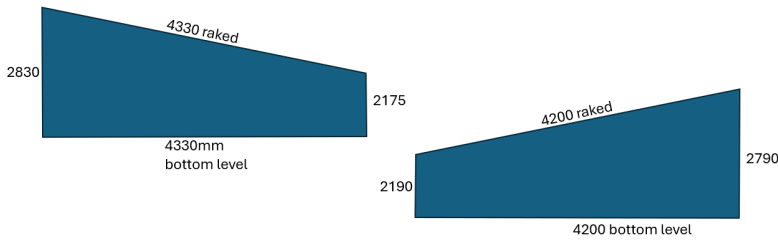

### SPECIFICATIONS

#### Bay 3

MATERIAL	Corflute / PVC
LENGTH	A – 2.25m B – 4.55m
HEIGHT	0.85m

### SPECIFICATIONS

#### Side Wings

MATERIAL	Corflute / PVC
----------	----------------

## INTERNAL Members Stand – Upper/Tier Rectangle Banner



### SPECIFICATIONS

#### LEFT HAND SIDE

MATERIAL	Corflute
LENGTH	20.6m
HEIGHT	0.58m

### SPECIFICATIONS

#### RIGHT HAND SIDE

MATERIAL	Corflute
LENGTH	20.5m
HEIGHT	0.58m

**INTERNAL**

**Sinclair Stand – Upper/Tier Rectangle Banner**

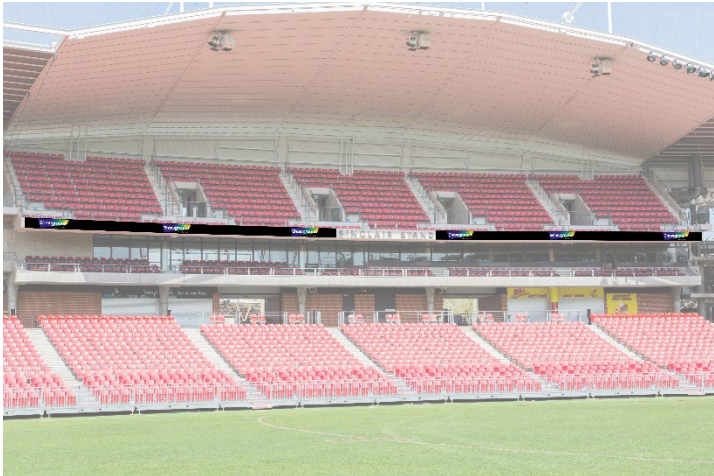

**SPECIFICATIONS**  
**LEFT HAND SIDE**

MATERIAL	Corflute
LENGTH	20.65m
HEIGHT	0.58m

**SPECIFICATIONS**  
**RIGHT HAND SIDE**

MATERIAL	Corflute
LENGTH	20.45m
HEIGHT	0.58m

**INTERNAL**

**Suttor Stand – Upper/Tier Rectangle Banner**

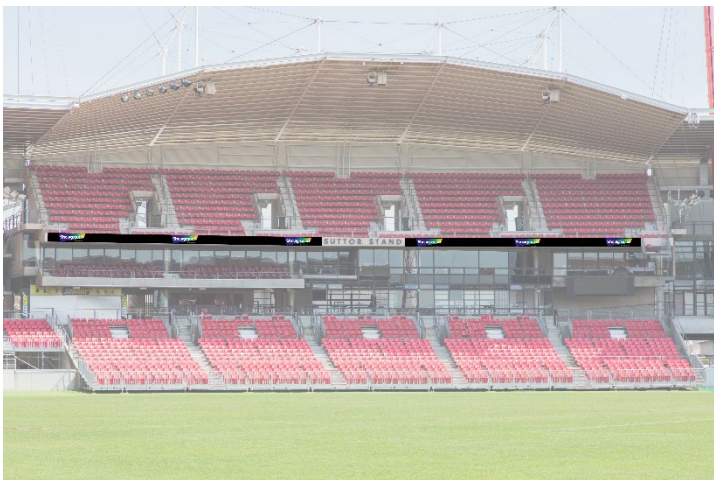

**SPECIFICATIONS**  
**LEFT HAND SIDE**

MATERIAL	Corflute
LENGTH	29.3m
HEIGHT	0.58m

**SPECIFICATIONS**  
**RIGHT HAND SIDE**

MATERIAL	Corflute
LENGTH	18.5m
HEIGHT	0.58m



**INTERNAL**

**Vincent Fairfax Stand – Rectangle Banner**

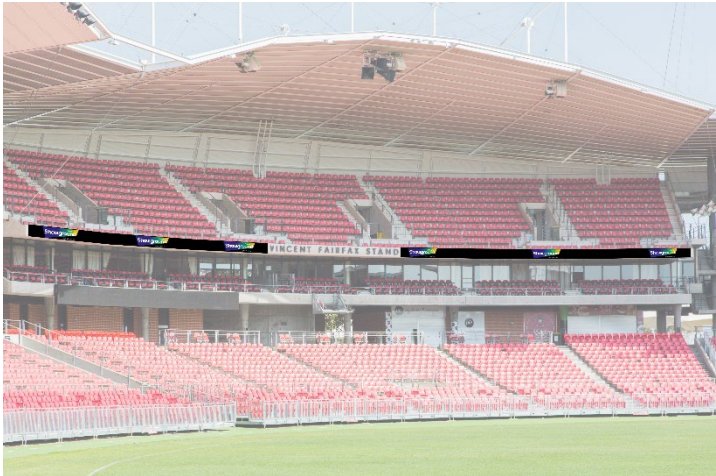

**SPECIFICATIONS**  
**LEFT HAND SIDE**

MATERIAL	Corflute
LENGTH	21.5m
HEIGHT	0.58m

**SPECIFICATIONS**  
**RIGHT HAND SIDE**

MATERIAL	Corflute
LENGTH	21.55m
HEIGHT	0.58m

**INTERNAL**

**Martin & Angus Stand – Rectangle Banner**

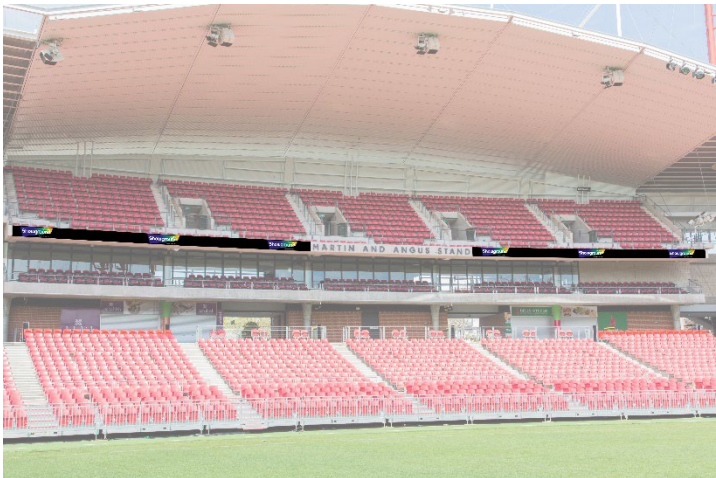

**SPECIFICATIONS**  
**LEFT HAND SIDE**

MATERIAL	Corflute
LENGTH	46.5m
HEIGHT	0.58m

**SPECIFICATIONS**  
**RIGHT HAND SIDE**

MATERIAL	Corflute
LENGTH	47.2m
HEIGHT	0.58m

## INTERNAL

### Sydney Royal Stand – Rectangle Banner



#### SPECIFICATIONS

MATERIAL	Corflute
LENGTH	45m
HEIGHT	0.7m

## VOM 3 TUNNEL SIGNAGE

## INTERNAL

### Overhead Signage

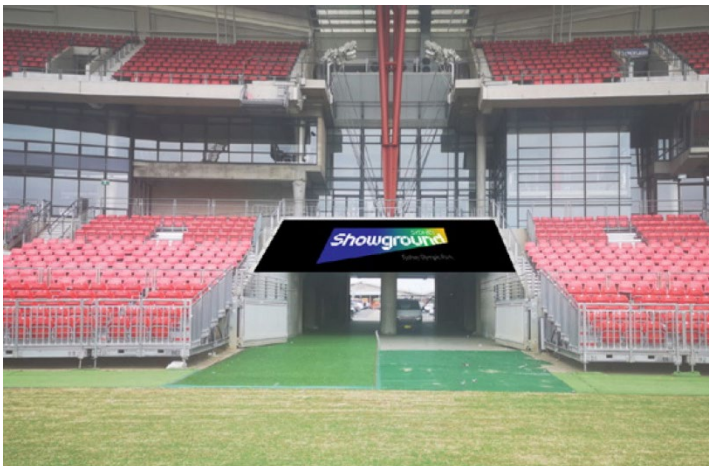

#### SPECIFICATIONS

##### KEDDAR BANNER DIMENSIONS

MATERIAL	PVC Banner, Keddar Edge
WIDTH	9.08m
HEIGHT	4.93m

## VOM 3 TUNNEL SIGNAGE

INTERNAL

Wall Banner



SPECIFICATIONS	
OVERALL DIMENSIONS	
MATERIAL	PVC Banner, Keddar Edge
SIDE A	1.58m
SIDE B	7.13m
SIDE C	4.09m

INTERNAL

Wall Banner



SPECIFICATIONS	
OVERALL DIMENSIONS	
MATERIAL	PVC Banner, Keddar Edge
SIDE A	6m
SIDE B	2.13m
SIDE C	2.26m



SYDNEY ROYAL STAND FOYERS

INTERNAL

Banners



SPECIFICATIONS

TRACK WIDTH

WIDTH	3m
-------	----

SPECIFICATIONS

BANNER DIMENSIONS

MATERIAL	PVC Banner
WIDTH	1.2m
HEIGHT	2.4m

SKYDECK

EXTERNAL

Left Return



SPECIFICATIONS	
MATERIAL	3.5mm Di Bond Panel
WIDTH	3.375m
HEIGHT	0.602m

EXTERNAL

Left Return



SPECIFICATIONS	
MATERIAL	3.5mm Di Bond Panel
WIDTH	10.820m
HEIGHT	0.602m

SKYDECK

EXTERNAL

Right Return



SPECIFICATIONS	
MATERIAL	3.5mm Di Bond Panel
WIDTH	3.280m
HEIGHT	0.602m



## CHARLEY ROOM

### INTERNAL

#### Second Privacy Screen



#### SPECIFICATIONS

##### OVERALL DIMENSIONS

WIDTH	2.4m
HEIGHT	2.55m

#### SPECIFICATIONS

##### BANNER DIMENSIONS

MATERIAL	PVC Banner
WIDTH	1.13m
HEIGHT	2.4m

### INTERNAL

#### Bathroom Banners



#### SPECIFICATIONS

##### OVERALL DIMENSIONS

WIDTH	5.75m
HEIGHT	2.34m

#### SPECIFICATIONS

##### BANNER DIMENSIONS

MATERIAL	PVC Banner
WIDTH	0.93m
HEIGHT	2.28m

**CHARLEY ROOM**

INTERNAL

**Hanging Panels**



**SPECIFICATIONS**  
**TRACK WIDTH**

WIDTH	2.4m
-------	------

**SPECIFICATIONS**  
**PANEL DIMENSIONS**

MATERIAL	PVC Banner
WIDTH	1.2m
HEIGHT	0.8m

CHANGE ROOM 1

INTERNAL

Hanging Panels

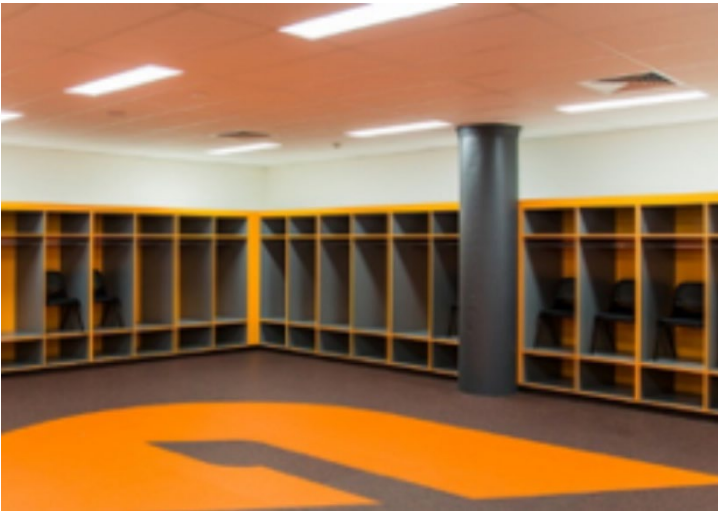

SPECIFICATIONS	
TRACK WIDTH	
WIDTH	2m

SPECIFICATIONS	
BANNER DIMENSIONS	
MATERIAL	Corflute
WIDTH	2.4m
HEIGHT	1.2m

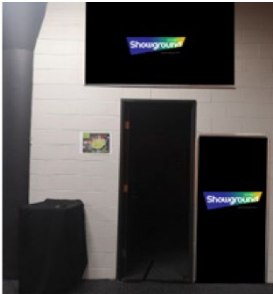
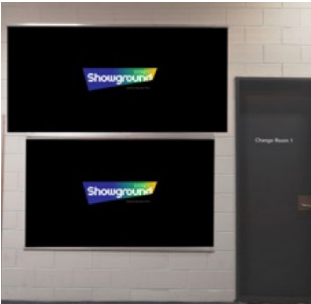



## CHANGE ROOM 2

INTERNAL

### Wall Banner - A



SPECIFICATIONS	
OVERALL DIMENSIONS	
MATERIAL	Corflute
LENGTH	3.6m
HEIGHT	1.16m

INTERNAL

### Wall Banner - C



INTERNAL

### Wall Banner - B



SPECIFICATIONS	
OVERALL DIMENSIONS	
MATERIAL	Corflute
LENGTH	Top left 4.63m Top right 4.18m Bottom 9.39m
HEIGHT	Top 1.16m Bottom 1.19m

SPECIFICATIONS	
OVERALL DIMENSIONS	
MATERIAL	Corflute
LENGTH	3.6m
HEIGHT	1.2m

## CHANGE ROOM 2

### INTERNAL

#### Wall Banner - D



#### SPECIFICATIONS OVERALL DIMENSIONS

MATERIAL	Corflute
LENGTH	3.75m
HEIGHT	1.16m

### INTERNAL

#### Wall Banner - E



#### SPECIFICATIONS OVERALL DIMENSIONS

MATERIAL	Corflute
LENGTH	Top 9.7m Bottom 6.1m
HEIGHT	1.16m

## CHANGE ROOM 2

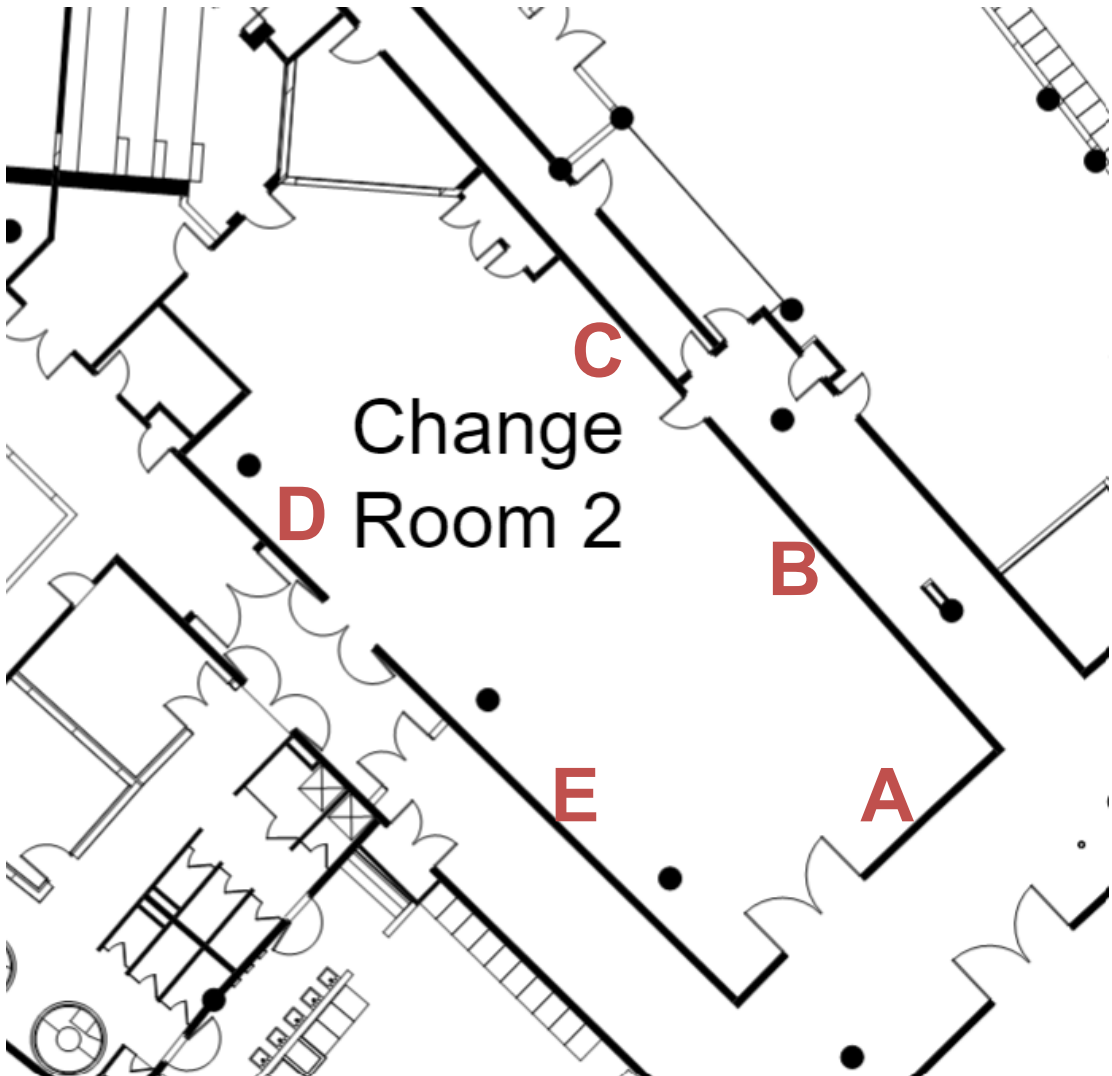



**STADIUM LIFTS**

INTERNAL



SPECIFICATIONS OVERALL DIMENSIONS	
MATERIAL	Decal
LENGTH	Level 2 & 3 Jamison Stand – 1010mm Level 2 & 3 Members Stand – 1010mm Level 2 & 3 Council Stand – 910mm Level 2 - 4 Sydney Royal Stand – 1100mm
HEIGHT	All lift heights 2100mm

# PRECINCT





## EXTERNAL Blade



SPECIFICATIONS	
MATERIAL	3mm corflute
OVERALL	H3500mm x W900mm
FRONT	1220 x 900mm x 2 panels
BACK	1220 x 900mm x 2 panels
QTY	15
PRICE	\$70.00 per sign

## EXTERNAL Column – Medium Blade



SPECIFICATIONS	
MATERIAL	3mm corflute
OVERALL	H2870mm x W600mm
PANEL 1 SIZE	910 x 590mm x 2 panels
PANEL 2 SIZE	910 x 590mm x 2 panels
QTY	10
PRICE	\$50.00 per sign



EXTERNAL

**Showground Rd & Grand Parade Banners**



**SPECIFICATIONS**

MATERIAL	Woven Polyester (large/small)
SHOWGROUND	H5.3m x W0.94m
GRAND	H2.98m x W0.89m
PRICE	\$72.00 per pole, per week*

Refer to SOPA Signage Guidelines for further information.  
 SOPA approval is required for any banner installation along Showground Rd.  
 Installation requires a work permit from SOPA prior to undertaking.  
 \*Price excludes installation

EXTERNAL

**Two-window Ticket Booth**



**SPECIFICATIONS**

BETWEEN GLASS WINDOWS	H785mm x W450mm
ABOVE GLASS WINDOWS	H410mm x W1450mm

## MAP

### Flag pole locations



# DIGITAL SIGNAGE





## Extend Your Brand at your next Sydney Showground event

Sydney Showground have two prime locations where there is opportunity to display digital event signage or event branding; the exterior of the Dome entrance, and the interior Dome foyer.

### Exterior Dome Entrance 3mm Transparent LED

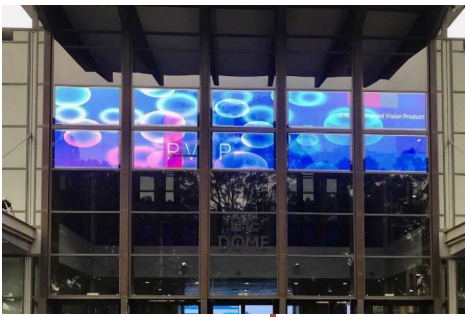

### Interior Dome Foyer 2mm LED

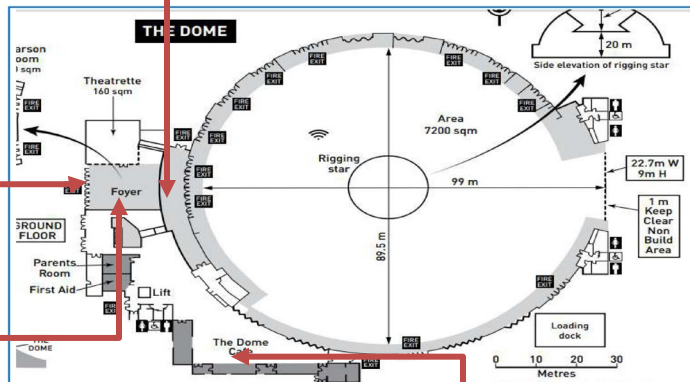

### Dome Foyer

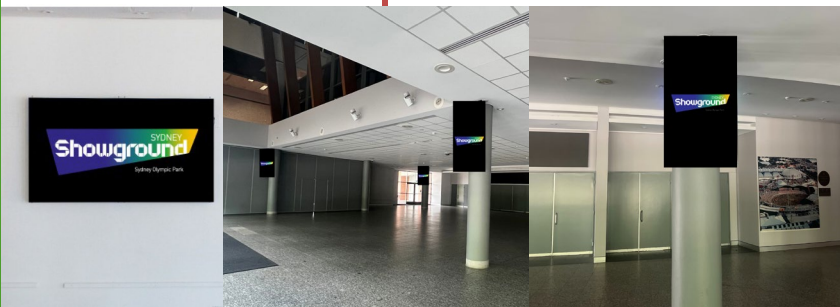

### Dome Cafe





**Introducing Sydney Showground Digital Screens. What a great way to extend your brand during your expo, or a great addition to your sponsorship suite (you can on-sell the screens to your customers or provide them as a value add).**

### Screen Locations

- Dome Foyer side wall 100% of time
- Dome entry doors 100% of time
- Dome Foyer pillars 100% of time
- Dome Café screens 50% of time
- (eg 30 seconds in every minute or 3 x 10 second blocks)
- All other screens 10 seconds or 16%+ of time
- 20 screens in total across the Dome and Halls.

Speak to your Account Manager or Event Representative for more details on how our digital signage solution can add value to your event.

### Costs:

Interior Cafe screens	\$500
Dome Foyer pillar screens	\$500
Dome Foyer wall Screen	\$350
Interior Dome Foyer LED	\$500
Exterior Dome Entrance LED	\$1000

Dome Foyer Screen Package \$1000  
(includes 4 pillar screens, side wall and interior LED screen)

All pricing is based per event.

### Specifications – Dome Foyer & Cafes

#### *Images*

Portrait – JPEG, 1080x1920, 72dpi, RGB

Landscape – JPEG, 1920x1080, 72dpi, RGB

#### *Animation*

Flash - .swf

#### *Movie*

Windows Media Video - .wmv

Portrait 1080x1920, 25fps, 8000 bits

Landscape

1920x1080, 25fps, 8000 bits

#### *Screen Zoning*

When screen zoning is required – multiple playlists or media files on each screen, the area of 1920x1080 or 1080x1920 can be divided to whatever is required.

The media files associated to those zones should be created in the same aspect ratio as the area zoned.

For example: If you have a landscape screen with two zones, split down the middle, the resolution of each zone would be 960x1080.

## The Dome Digital Signage – Technical Specifications

### Exterior Dome LED Entrance 3mm Pitch, Transparent LED

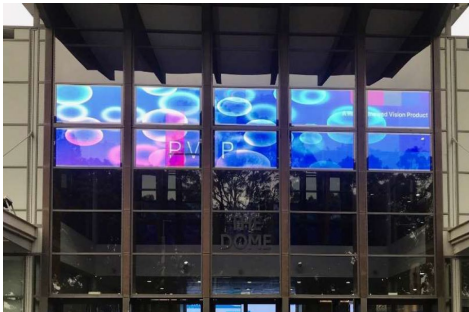

#### 10 x Individual Panels

Individual panel pixel size - 504 W x 256 H  
Overall pixel size - 2520 W x 512 H Black/  
dark gradient colours create the transparent effect  
eg. 100% black = 100% transparent

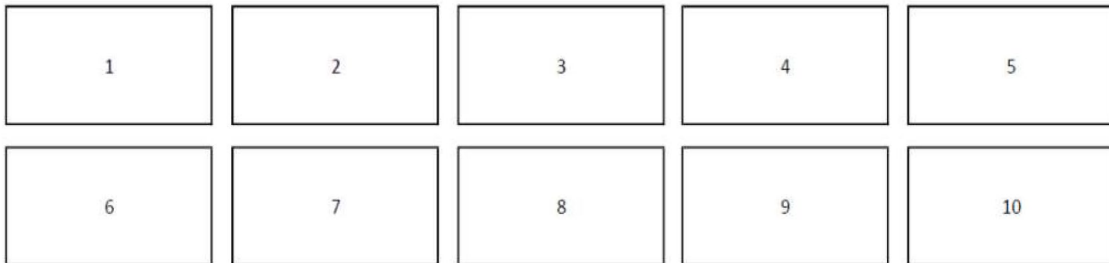

FILE	
VIDEO	.MP4 (H264)
	.AVI
STATIC	.JPEG
	.GIF
	.BMP
	.PNG

- Other file types may be possible, or may have to be converted to one of the above files types. Additional charges may be incurred.
- A sample file must be submitted 14 days before tenancy for testing purposes, and the final files 7 days before event commences.
- Should you not wish to utilise the Dome screens, Sydney Showground will display safety and venue messaging.

## The Dome Digital Signage – Technical Specifications

**Interior Dome LED Entrance**  
Overall pixel size - 3456 W x 384 H



FILE	
VIDEO	.MP4 (H264)
	.AVI
STATIC	.JPEG
	.GIF
	.BMP
	.PNG

- Other file types may be possible, or may have to be converted to one of the above files types. Additional charges may be incurred.
- A sample file must be submitted 14 days before tenancy for testing purposes, and the final files 7 days before event commences.
- Should you not wish to utilise the Dome screens, Sydney Showground will display safety and venue messaging.

## Dome – Somerville & Pearson Screens

**Pearson Room**  
65inch TV

**Somerville Room**  
65inch TV

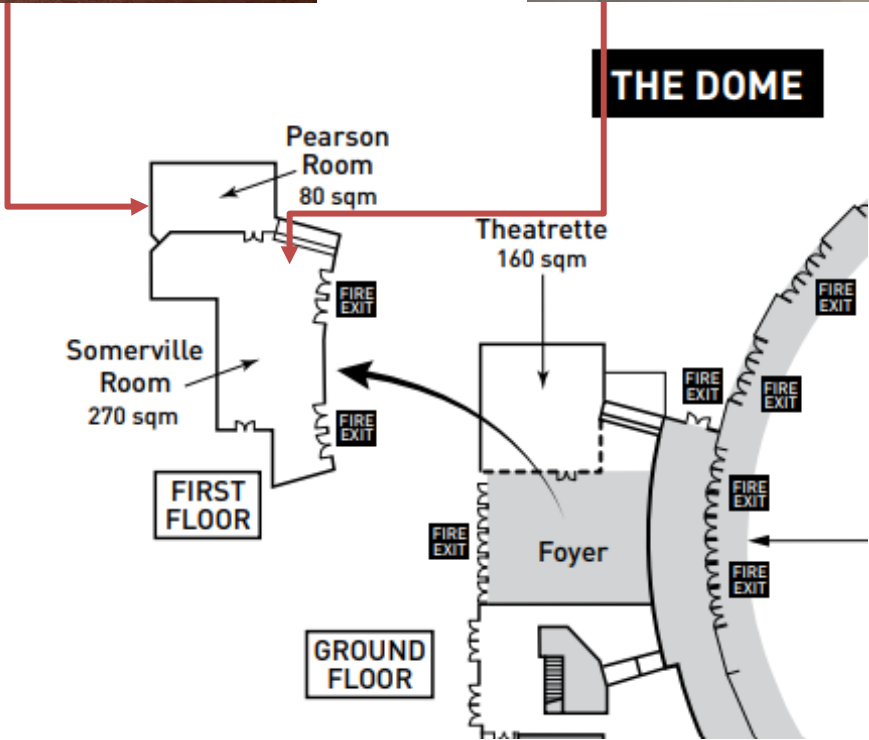



## Dome – Somerville & Pearson Screens

### Screen Locations

- Somerville & Pearson screens 100% of time, useful for presentations

Speak to your Account Manager or Event Representative for more details on how our digital signage solution can add value to your event.

### Costs:

Somerville	\$200
Pearson	\$200

All pricing is based per event.

### Specifications – Dome Foyer & Cafes

#### *Images*

Landscape – JPEG, 1920x1080, 72dpi, RGB

#### *Animation*

Flash - .swf

#### *Movie*

Windows Media Video - .wmv

Portrait 1080x1920, 25fps, 8000 bits

Landscape

1920x1080, 25fps, 8000 bits

#### *ClickShare Technology*

As part of the new digital signage system we have included ‘Clickshare’ on a number of monitors that enables wireless presentation to be undertaken direct from a laptop.

Each relevant monitor has a dongle plugged into a base station connected to the monitor which can be removed from the base station and inserted directly into a laptop that has a USB C port. Simply wait for it to ‘pair’ and off you go.

Any dongles damaged or lost will incur a replacement fee.

## Halls 2 – 4 Screens

### North Pod 65inch TV



### South Pod 65inch TV

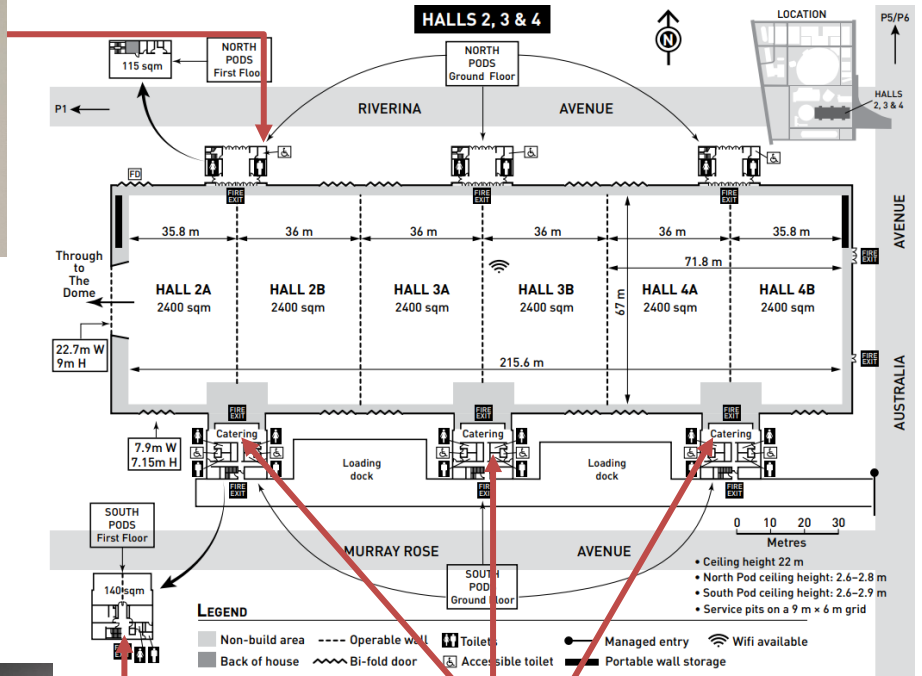

### Hall Cafés 50inch TVs

## Halls 2 – 4 Screens

### Screen Locations

- Hall Café screens 50% of time
- (eg 30 seconds in every minute or 3 x 10 second blocks)
- North & South Pods 100% of time, useful for presentations

Speak to your Account Manager or Event Representative for more details on how our digital signage solution can add value to your event.

### Costs:

Pod screens	\$200
Hall Café Screens (3 per cafe)	\$500

All pricing is based per event.

### Specifications – Dome Foyer & Cafes

#### *Images*

Landscape – JPEG, 1920x1080, 72dpi, RGB

#### *Animation*

Flash - .swf

#### *Movie*

Windows Media Video - .wmv

Portrait 1080x1920, 25fps, 8000 bits

Landscape

1920x1080, 25fps, 8000 bits

#### *ClickShare Technology*

As part of the new digital signage system we have included 'Clickshare' on a number of monitors that enables wireless presentation to be undertaken direct from a laptop.

Each relevant monitor has a dongle plugged into a base station connected to the monitor which can be removed from the base station and inserted directly into a laptop that has a USB C port. Simply wait for it to 'pair' and off you go.

Any dongles damaged or lost will incur a replacement fee.

# Halls 5 & 6 Screens

**Hall 5 Foyer**  
55inch TV



**Function Room 5**  
75inch TV

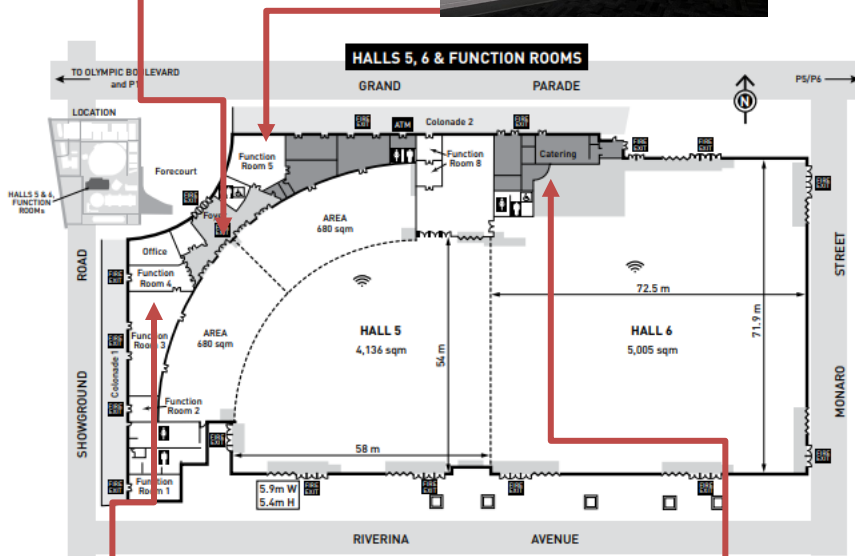

**Function Room 3**  
75inch TV

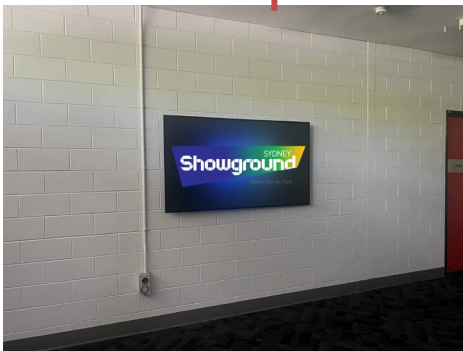

**Hall 6 Café**  
75inch TV

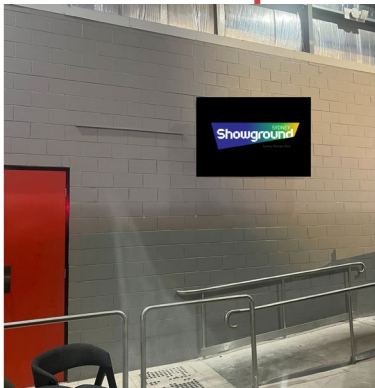



## Halls 5 & 6 Screens

### Screen Locations

- Hall 5 Foyer 100% of time
- Hall 6 Café screens 50% of time
- (eg 30 seconds in every minute or 3 x 10 second blocks)
- Function Rooms 3 & 5 100% of time, useful for presentations

Speak to your Account Manager or Event Representative for more details on how our digital signage solution can add value to your event.

### Costs:

Hall 5 Foyer screen	\$200
Function Room screens	\$200
Hall 6 Café Screen	\$250

All pricing is based per event.

### Specifications – Dome Foyer & Cafes

#### *Images*

Landscape – JPEG, 1920x1080, 72dpi, RGB

#### *Animation*

Flash - .swf

#### *Movie*

Windows Media Video - .wmv

Portrait 1080x1920, 25fps, 8000 bits

Landscape

1920x1080, 25fps, 8000 bits

#### *ClickShare Technology*

As part of the new digital signage system we have included ‘Clickshare’ on a number of monitors that enables wireless presentation to be undertaken direct from a laptop.

Each relevant monitor has a dongle plugged into a base station connected to the monitor which can be removed from the base station and inserted directly into a laptop that has a USB C port. Simply wait for it to ‘pair’ and off you go.

Any dongles damaged or lost will incur a replacement fee.

## Stadium Level 2 Parapet

### Video

LED  
1600W x 72H



LED  
1040W x 72H



LED  
720W x 72H



#### VIDEO

PIXEL DIMENSIONS	1040 x 72px 720 x 72px
ANIMATION DURATION	30 seconds
FRAMES PER SECOND	30 (FPS) Use the whole stage as there is no safe zone

We recommend using video versus static images. The movement/animation in video provides a higher impact and engagement with fans.

# SIGNAGE REQUIREMENTS



## Sydney Showground Minimum Requirements for Signage

### 1. Minimum Manufacturing Requirements

The minimum manufacturing requirements are:

- I. Load:
  - a. Top pocket or eyelets – 14kg per lineal metre of the width plus the weight of banner.
  - b. Bottom pocket – 14kg per lineal metre of the width of the banner.
- II. Pockets to be hot air welded and stitched.
- III. Eyelets to be reinforced (webbing affixed).

Please ensure that all manufacturers undertaking Sydney Showground work through you are made aware of these minimum manufacturing requirements and provide a Quality Assurance Statement from the supplier/manufacture stating that any newly produced signage meets or exceeds the standards outlined within the minimum manufacturing requirements and therefore is fit for purpose.

### 2. Minimum Rigging and De-Rigging Requirements

Any banner requiring hanging at a height above 2.4m must be rigged by the Sydney Showground authorised rigger.

Sydney Showground has a large rigging capacity within the Exhibition Halls & Secondary Pavilions; detailed plans are available on request. Rigging plans must be submitted to the Sydney Showground to review two weeks prior to the licence period commencing.

Rigging within Sydney Showground's secondary pavilions must be signed off by a certified structural engineer.

### 3. Minimum Installation Requirements

At all times the presentation standards of the Sydney Showground along with best practise installation methods are to be upheld.

The Sydney Showground does not permit the sticking, posting, hanging or attaching of any signage, notices, banners or advertisements on ceilings, floors, walls, walkways, railings, fences or any property belonging to the Sydney Showground without prior written approval. Any fixing items used must not damage Sydney Showground property. The cost of repair due to damage sustained from the use of nonapproved fixing agents will be borne by the Signage Installation company. Any damage caused will be charged back to the licensee.

Should a sign be affixed to a temporary structure or frame, the structure or frame must abide by the New South Wales, State Legislative Requirements as set out in the "State Environmental Planning Policy (Temporary Structures and Places of Public Entertainment) Amendment (Temporary Structures)– 2009" and be signed off by a certified structural engineer supplied by the Contractor responsible for the installation of the sign. Upon approval, an engineer's certificate must be provided to the Sydney Showground Signage Coordinator.

#### Site Wide Signage

Sydney Showground will seek permission on the licensee's behalf for any signage placed outside the Sydney Showground site from the local authority. This includes signage or banners placed on any fenceline that faces a roadway.

#### Promotional Signage

Promotional signage may be displayed only within the licensee's immediate licensed area. Permission and approval of all promotional signage is required prior to being displayed. Signage on site takes into consideration ALL events that are operational at any one time. The decision on how signage space is allocated is at the discretion of Sydney Showground.



## Naming

### **Naming Protocol**

The correct naming of the venue is:

*Sydney Showground at Sydney Olympic Park*

Sydney Showground is the venue and Sydney Olympic Park is the suburb. Under no circumstances are the words 'Homebush' or 'Homebush Bay' to be used on any print or digital signage or other marketing collateral including TV commercials and radio announcements.

Correct naming will ensure that your customers know exactly where to find the venue and your event. Use of incorrect suburb names can lead to confusion including customers getting off at the wrong train station or driving to the wrong suburb.

Please ensure final proof of signage is sent to your Event Planner prior to printing.



1 Showground Road, Sydney Olympic Park, NSW 2127 Australia  
 Phone +61 2 9704 1157 Email [sales@sydneyshowground.com.au](mailto:sales@sydneyshowground.com.au)  
[www.sydneyshowground.com.au](http://www.sydneyshowground.com.au)